

Long Distance Type

Dimensions

(unit: mm)

● PRDL(T)12-4D

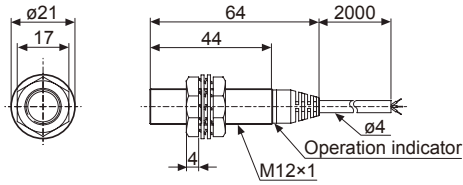

● PRDL(T)12-8D

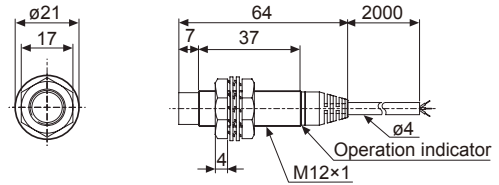

● PRD(T)18-7D

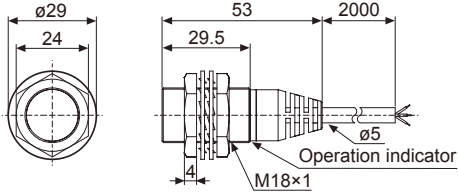

● PRD(T)18-14D

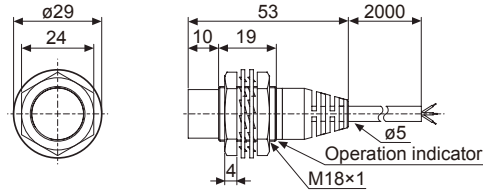

● PRDL(T)18-7D

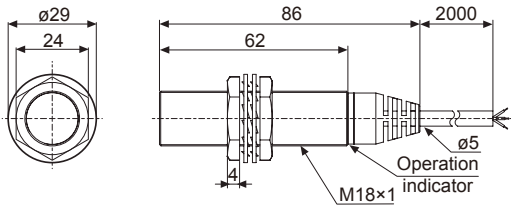

● PRDL(T)18-14D

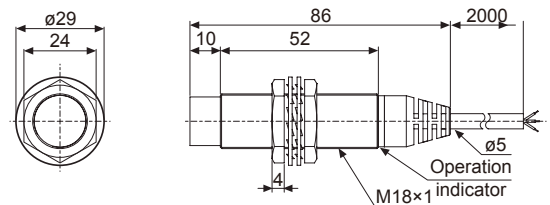

● PRD(T)30-15D

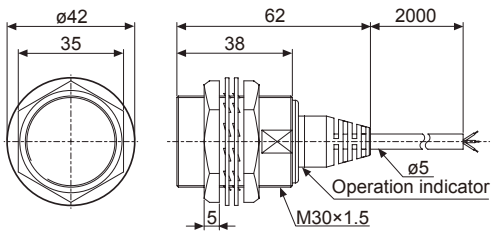

● PRD(T)30-25D

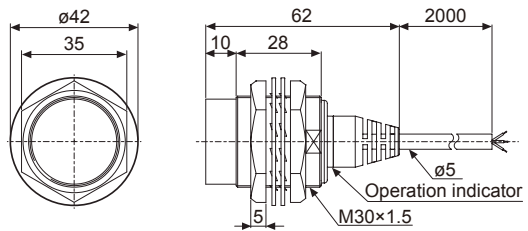

● PRDL(T)30-15D

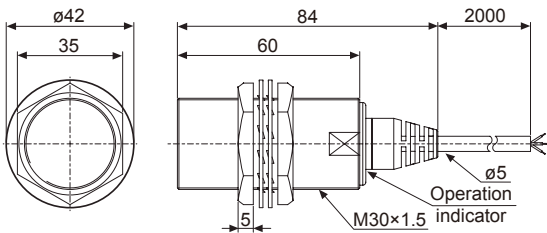

● PRDL(T)30-25D

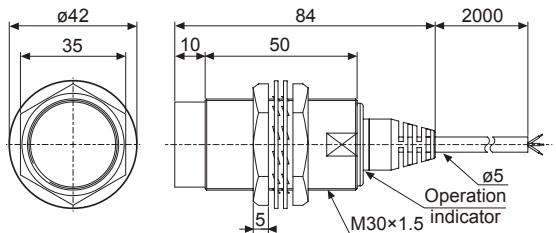

● PRDW(T)12-4D

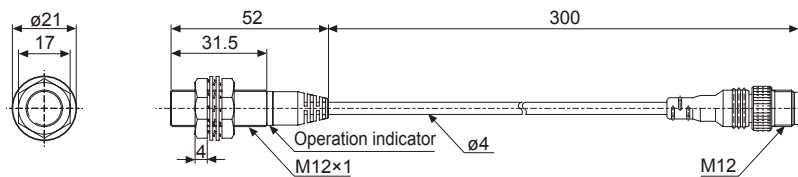

● PRDW(T)12-8D

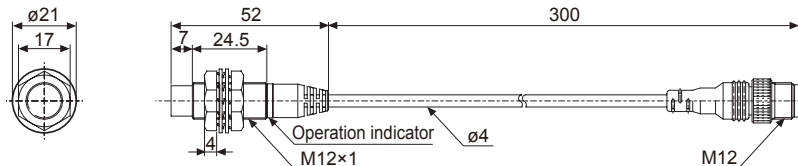

(A) Photo electric sensor

(B) Fiber optic sensor

(C) Door/Area sensor

(D) Proximity sensor

(E) Pressure sensor

(F) Rotary encoder

(G) Connector/Socket

(H) Temp. controller

(I) SSR/ Power controller

(J) Counter

(K) Timer

(L) Panel meter

(M) Tacho/ Speed/ Pulse meter

(N) Display unit

(O) Sensor controller

(P) Switching mode power supply

(Q) Stepper motor & Driver&Controller

(R) Graphic/ Logic panel

(S) Field network device

(T) Software

(U) Other

PRD/PRDW Series

■ Dimensions

(unit: mm)

● PRDWL12-4D

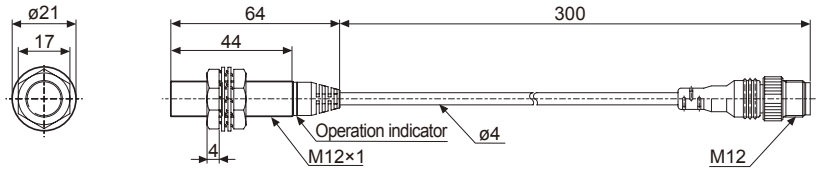

● PRDWL12-8D

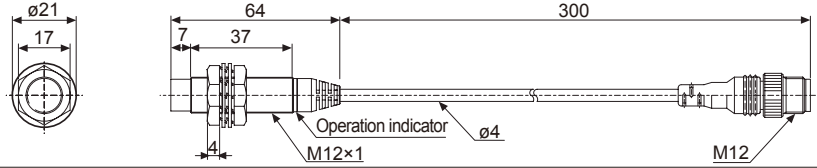

● PRDW(T)18-7D

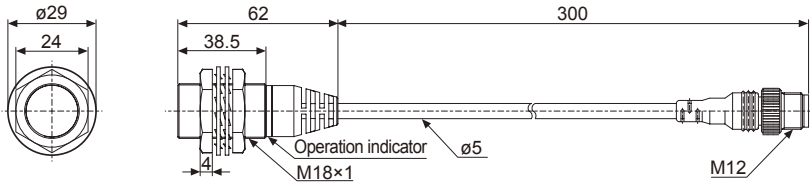

● PRDW(T)18-14D

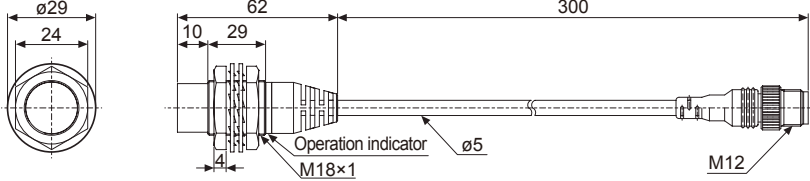

● PRDWL(T)18-7D

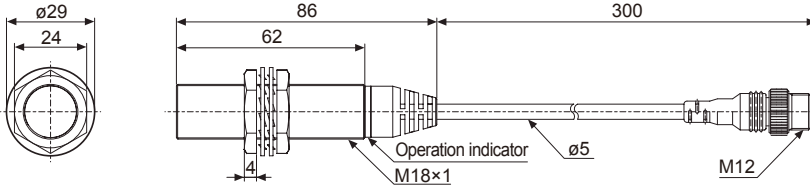

● PRDWL(T)18-14D

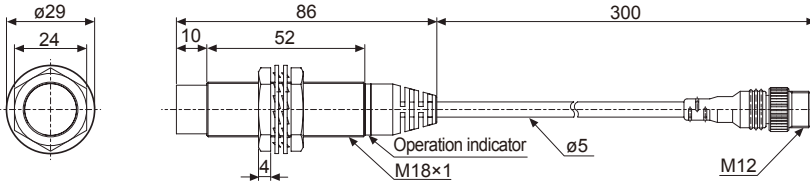

● PRDW(T)30-15D

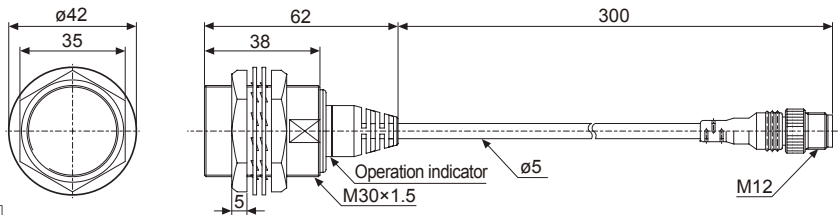

● PRDW(T)30-25D

