

## Engineering Data

### G9EC-1(-B) Switching/Current Conduction Models

#### Maximum Switching Capacity

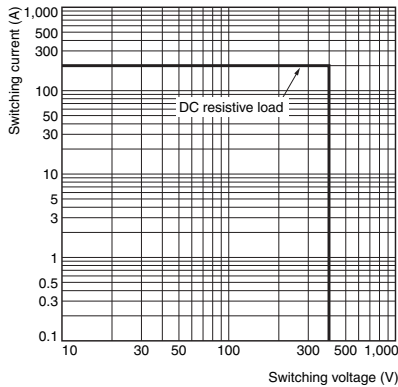

#### Carry Current vs Energizing Time

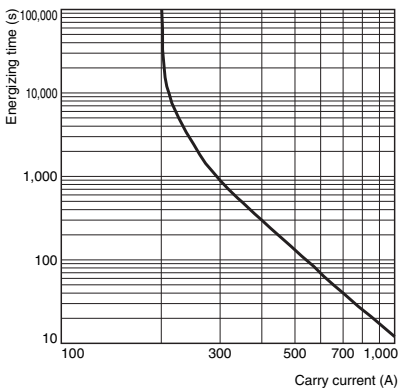

#### Vibration Malfunction

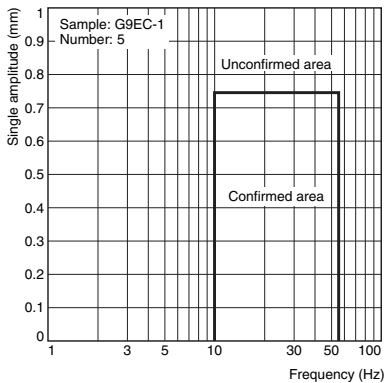

#### Shock Malfunction

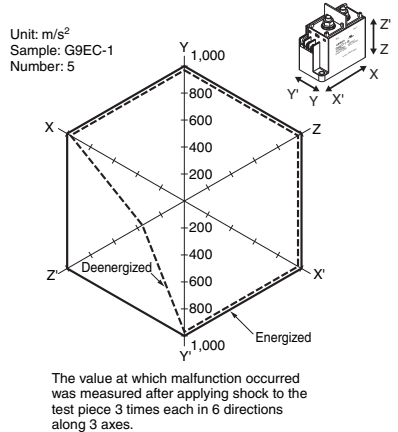

#### Electrical Endurance (Switching Performance)

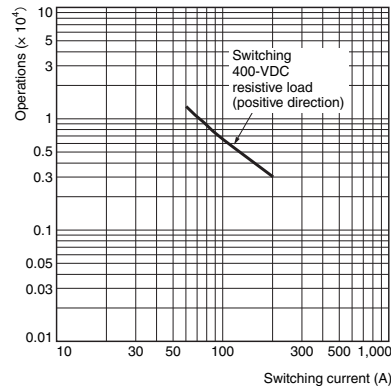

#### Must-operate Voltage and Must-release Voltage Distributions

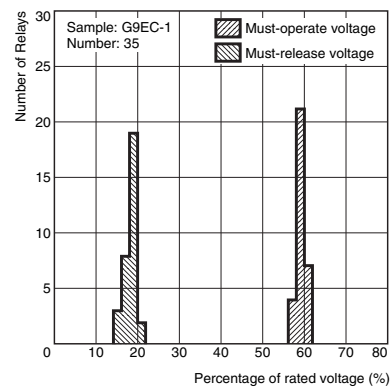

#### Vibration Resistance

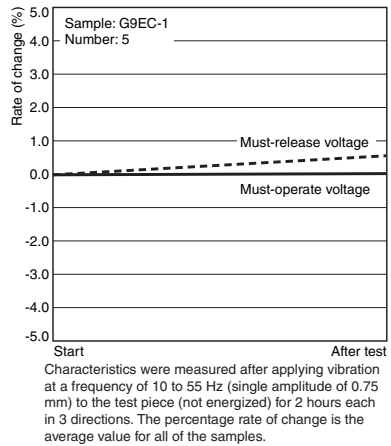

#### Shock Resistance

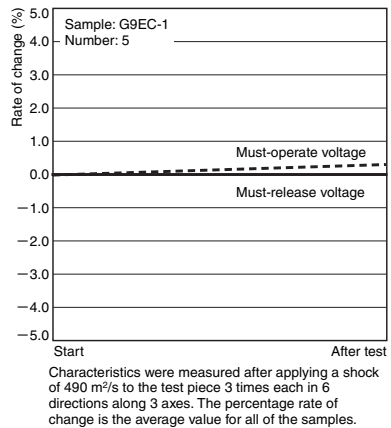

#### Electrical Endurance (Interruption Performance)

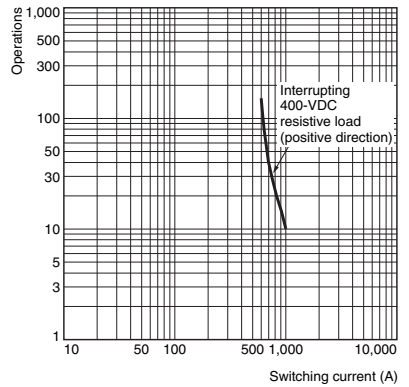

#### Time Characteristic Distributions

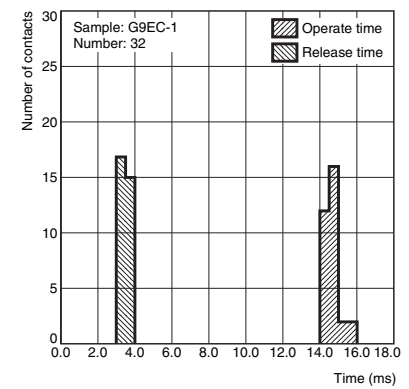

# G9EC-1

## DC Power Relays (200-A Models)

### ■Dimensions (Unit: mm)

#### ●Models with Screw Terminals G9EC-1-B

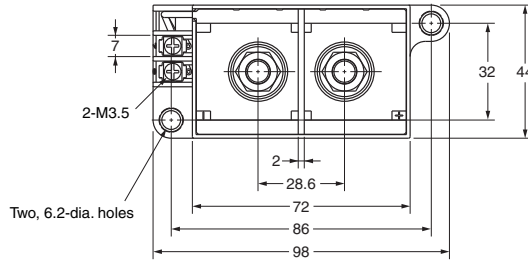
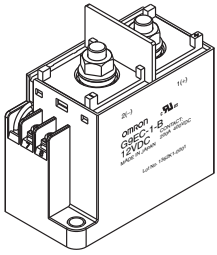

#### Terminal Arrangement/ Internal Connections (TOP VIEW)

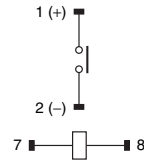

Note: Be sure to connect terminals with the correct polarity. Coils do not have polarity.

#### Mounting Hole Dimensions (TOP VIEW)

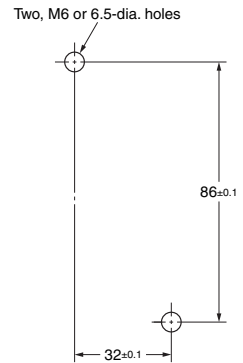

Dimension (mm)	Tolerance (mm)
10 or lower	±0.3
10 to 50	±0.5
50 or higher	±1

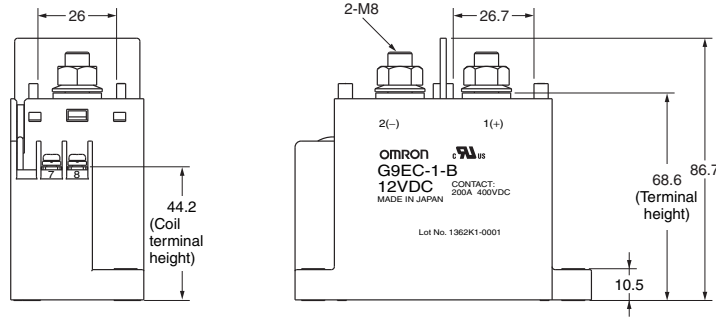

#### ●Models with Lead Wires G9EC-1

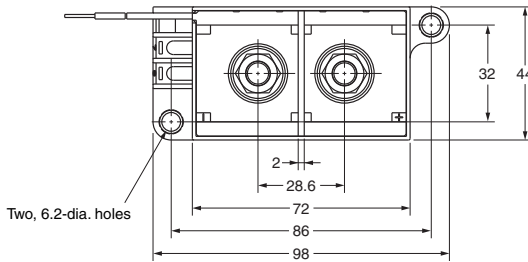
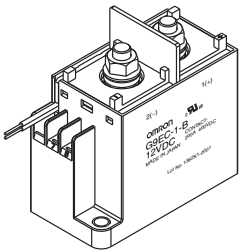

#### Terminal Arrangement/ Internal Connections (TOP VIEW)

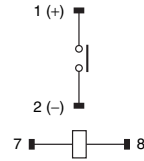

Note: Be sure to connect terminals with the correct polarity. Coils do not have polarity.

#### Mounting Hole Dimensions (TOP VIEW)

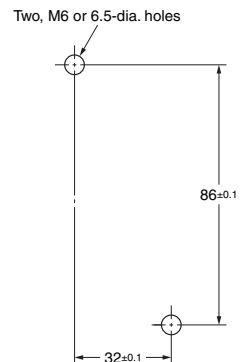

Dimension (mm)	Tolerance (mm)
10 or lower	±0.3
10 to 50	±0.5
50 or higher	±1

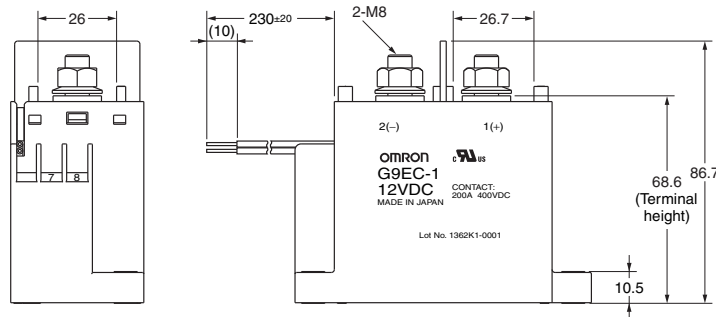

### ■Options (Unit: mm)

#### ●Terminal Cover P9EC-C

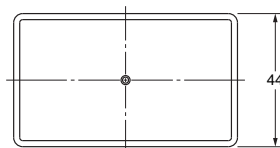
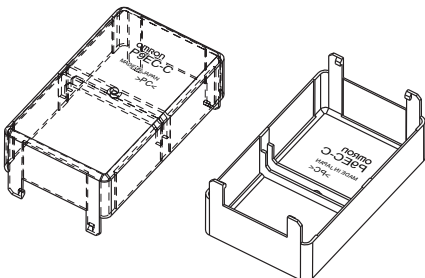

\* Dimensions of cutout for wiring.

Note: Be sure to remove the cutouts for wiring that are located in the wiring outlet direction before installing the Terminal Cover.

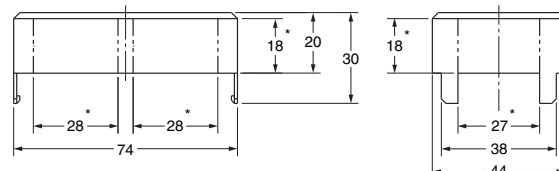

Dimension (mm)	Tolerance (mm)
10 or lower	±0.3
10 to 50	±0.5
50 or higher	±1