

Catalog numbers:

CCPB part numbers	Poles	Voltage rating	Accepts CUBEFuse amp range	Typical installed fuse amp range			Max. fuse amps†	SCCR	Hp ratings (Vac)††
				Time-delay non-indicating	Time-delay indicating*	Fast-acting non-indicating**			
CCPB-1-15CF	1	600 Vac, 125 Vdc	1 to 15	TCF1RN, TCF3RN, TCF6RN, TCF10RN, TCF15RN	TCF6, TCF10, TCF15	FCF1RN, FCF3RN, FCF6RN, FCF10RN, FCF15RN	15 A	200kA AC 100kA DC	0.5Hp@120V
CCPB-2-15CF	2								1.5Hp@240V
CCPB-3-15CF	3	600 Vac							3Hp@240V 5Hp@480V 7.5Hp@600V
CCPB-1-20CF	1	600 Vac, 125 Vdc	1 to 20	TCF17-1/2RN, TCF20RN	TCF17-1/2, TCF20	FCF20RN	20 A	200kA AC 100kA DC	0.75Hp@120V
CCPB-2-20CF	2								2Hp@240V
CCPB-3-20CF	3	600 Vac							3Hp@240V 7.5Hp@480V 10Hp@600V
CCPB-1-30CF	1	600 Vac, 125 Vdc	1 to 30	TCF25RN, TCF30RN	TCF25, TCF30	FCF25RN, FCF30RN	30 A	200kA AC 100kA DC	1.5Hp@120V
CCPB-2-30CF	2								3Hp@240V
CCPB-3-30CF	3	600 Vac							5Hp@240V 15Hp@480V 10Hp@600V
CCPB-1-40CF	1	600 Vac, 125 Vdc	1 to 40	TCF35RN, TCF40RN	TCF35, TCF40	FCF35RN, FCF40RN	40 A	200kA AC 100kA DC	2.0Hp@120V
CCPB-2-40CF	2								3Hp@240V
CCPB-3-40CF	3	600 Vac							7.5Hp@240V 20Hp@480V 10Hp@600V
CCPB-1-50CF	1	600 Vac	1 to 50	TCF45RN, TCF50RN	TCF45, TCF50	FCF45RN, FCF50RN	50 A	200kA AC 100kA DC	3.0Hp@120V
CCPB-2-50CF	2								5Hp@240V
CCPB-3-50CF	3	600 Vac							7.5Hp@240V 20Hp@480V 10Hp@600V
CCPB-1-60CF	1	600 Vac	1 to 60	TCF60RN	TCF60	FCF60RN	60 A	200kA AC 100kA DC	3.0Hp@120V
CCPB-2-60CF	2								7.5Hp@240V
CCPB-3-60CF	3	600 Vac							7.5Hp@240V 20Hp@480V 10Hp@600V
CCPB-1-70CF	1	600 Vac, 125 Vdc	1 to 70	TCF70RN	TCF70	FCF70RN	70 A	200kA AC 100kA DC	3.0Hp@120V
CCPB-2-70CF	2								7.5Hp@240V
CCPB-3-70CF	3	600 Vac							15Hp@240V 30Hp@480V 40Hp@600V
CCPB-1-90CF	1	600 Vac, 125 Vdc†††	1 to 90	TCF90RN	TCF90	FCF80RN, FCF90RN	90 A	200kA AC 100kA DC	5.0Hp@120V
CCPB-2-90CF	2								10Hp@240V
CCPB-3-90CF	3	600 Vac							20Hp@240V 50Hp@480V 40Hp@600V
CCPB-1-100CF	1	600 Vac	1 to 100	TCF100RN	TCF100	FCF100RN	100 A	200kA AC	5.0Hp@120V
CCPB-2-100CF	2								10Hp@240V
CCPB-3-100CF	3								20Hp@240V 50Hp@480V 40Hp@600V

* 1 A and 3 A indicating Bussmann series CUBEFuse not available. Correct fit with CCPB disconnect requires indicating Bussmann series CUBEFuse with date code R38 or later.

** Do not use UPS/Critical Application fast-acting FCF with motors.

† Any fuse with an amp rating less than or equal to the max fuse rating may be used. E.g., TCF15 may be used with CCPB-1-20CF.

†† Indicating or non-indicating time-delay Bussmann series CUBEFuse only.

††† 125Vdc only applies up to 80 A.

Dimensions — in (mm):

15-60 A

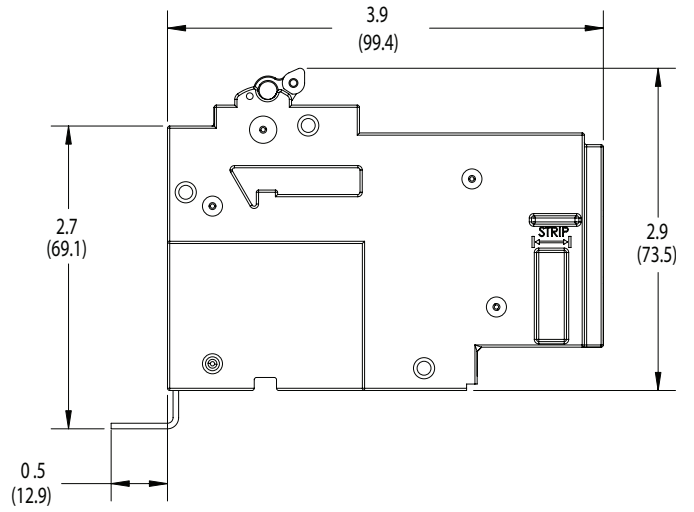
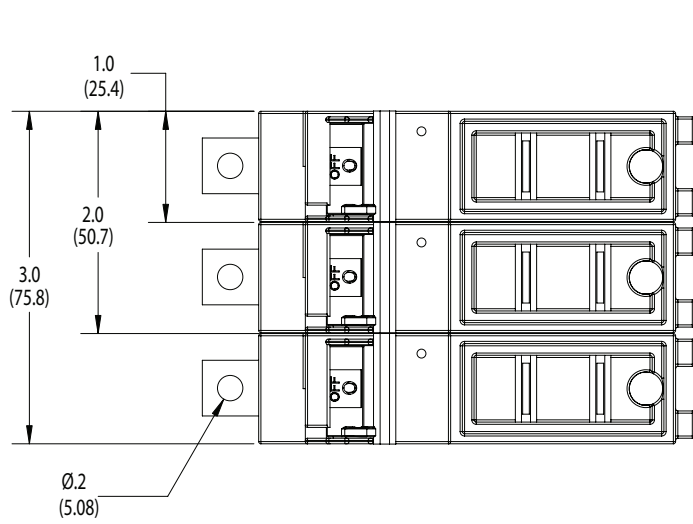

70-100A

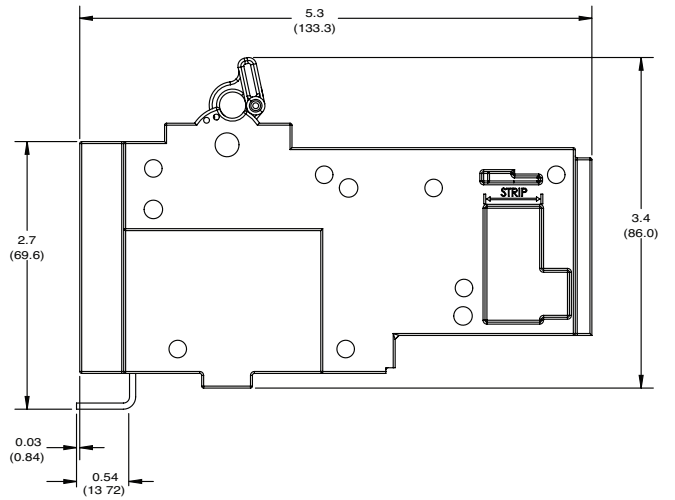
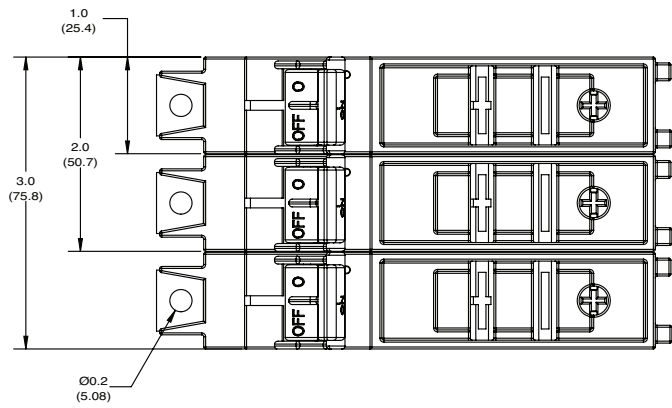

For details on the CCPB and its use in the Quik-Spec Coordination Panelboard, see data sheet 1160.