

PSAN Series

● Analog output voltage and current—Pressure characteristic

● Analog output voltage and current—Linear characteristic

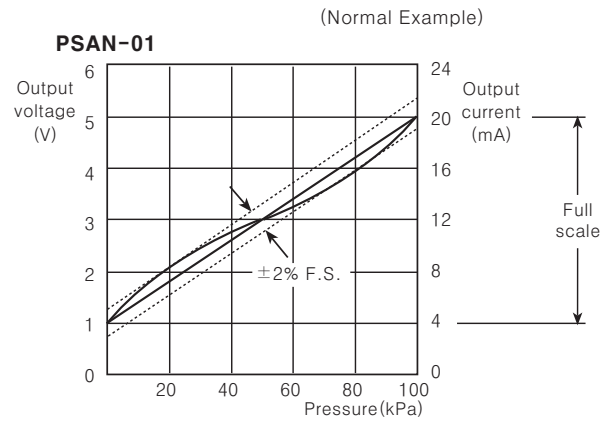
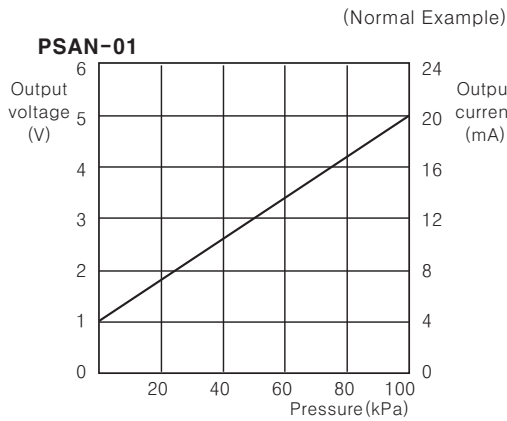

■ Dimensions

◎ Pneumatic type

(Unit:mm)

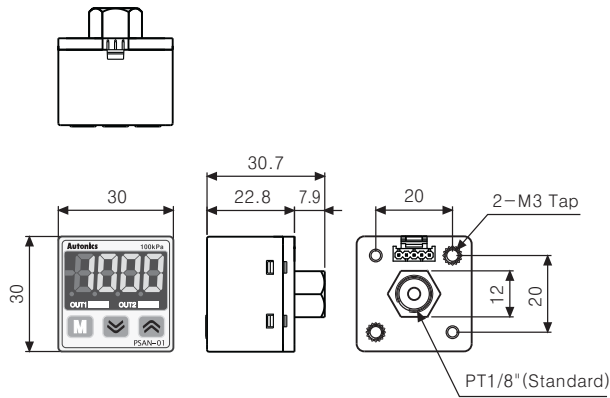

● Panel mounting bracket

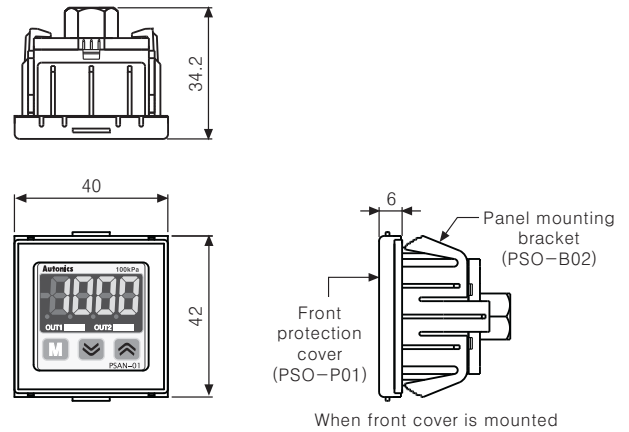

● Fixing bracket A for mounting

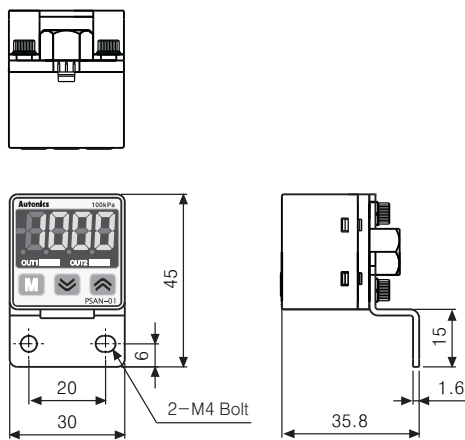

● Fixing bracket B for mounting

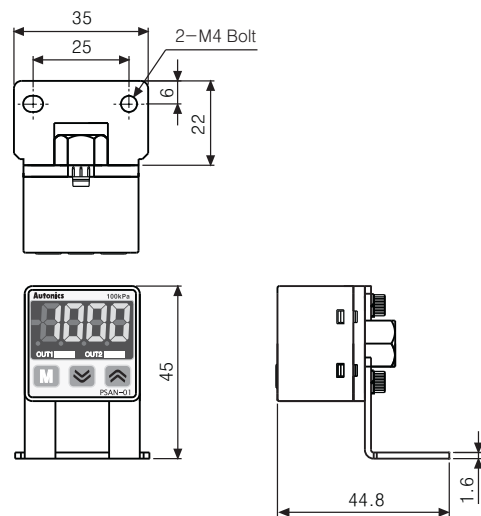

Pressure Sensor

Dimensions

Fluid type

(Unit:mm)

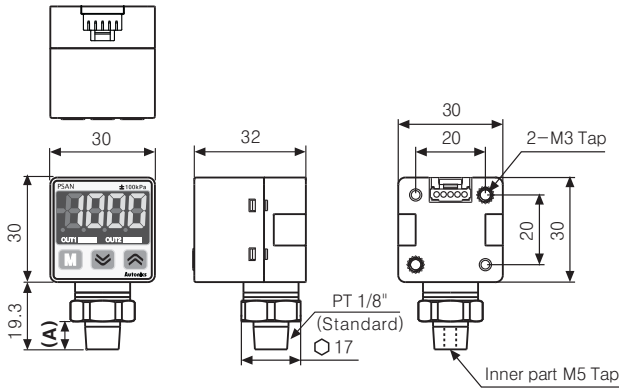

※ (A) PT1/8" model(Standard): 8, NPT1/8" model: 8,
7/16"-20 UNF model: 11
※ (*1) Only for PT1/8" model, NPT1/8" model

Panel mounting bracket

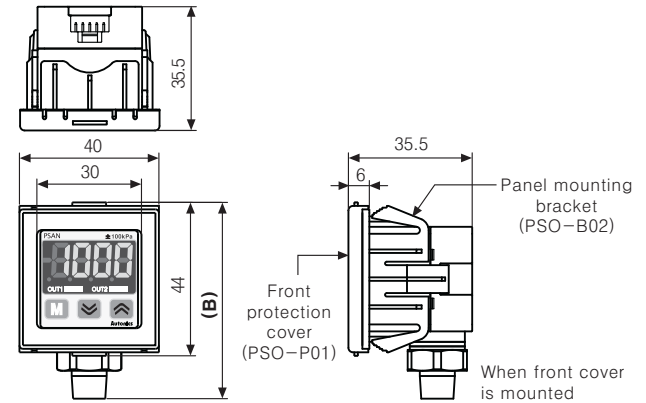

※ (B) PT1/8" model(Standard): 56.3, NPT1/8" model: 56.3,
7/16"-20 UNF model: 59.3

- (A) Photo electric sensor
- (B) Fiber optic sensor
- (C) Door/Area sensor
- (D) Proximity sensor
- (E) Pressure sensor
- (F) Rotary encoder
- (G) Connector/Socket
- (H) Temp. controller
- (I) SSR/Power controller
- (J) Counter
- (K) Timer
- (L) Panel meter
- (M) Tacho/Speed/Pulse meter
- (N) Display unit
- (O) Sensor controller
- (P) Switching power supply
- (Q) Stepping motor & Driver & Controller
- (R) Graphic/Logic panel
- (S) Field network device
- (T) Production stoppage models & replacement

Fixing bracket A for mounting

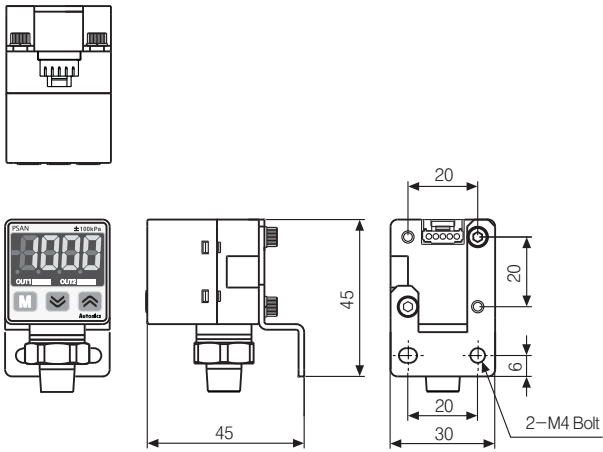

Fixing bracket B for mounting

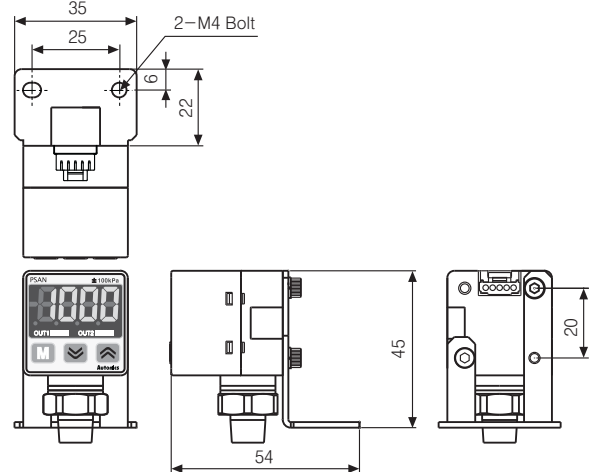

Accessory(Sold separately)

Panel cut-out

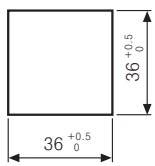

(Panel thickness : 0.8mm to 3.5mm)

Panel mounting bracket



< PSO-B02 >

Front protection cover

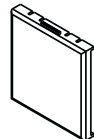

< PSO-P01 >

M5 Gender



< PSO-Z01 >

Accessory

Pressure unit label

±100kPa	-101.3kPa	2kPa	10kPa	100kPa	1MPa
±1.020kgf/cm ²	-1.034kgf/cm ²	2.040kgf/cm ²	10.20kgf/cm ²	1.020kgf/cm ²	10.20kgf/cm ²
±14.50psi	-14.70psi	29.00psi	145.0psi	14.50psi	145.0psi
±1.000bar	-1.013bar	2.000bar	10.00bar	1.000bar	10.00bar
±750mmHg	-760mmHg				
±29.5inHg	-29.9inHg			/100	/100
±10.20mmH ₂ O	-103.4mmH ₂ O	2.040mmH ₂ O	10.20mmH ₂ O	X100	X100

DISPLAY UNIT LABEL

Bracket A

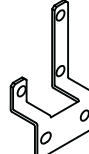

Bracket B

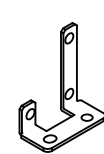

Connector cable(PSO-C01)

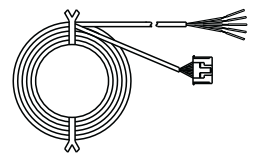

Bracket A

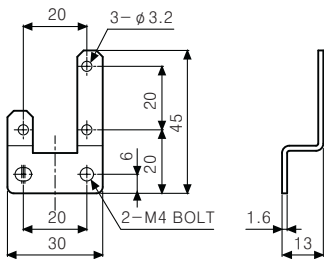

Bracket B

