	Scanning range 0 ... 4000 mm
Through-beam mode	
	Scanning distance 0 ... 160 mm
Proximity mode	

- Sender LED red for standard applications
- Manual sensitivity adjustment
- Simple installation and alignment

Dimensional drawing

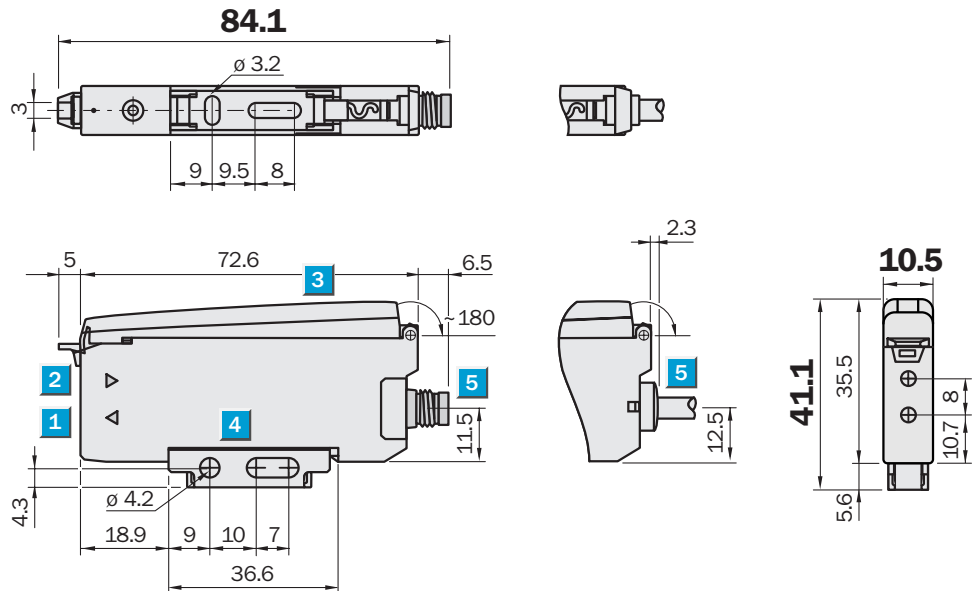

Adjustments possible



- 1 Sender LED, installation of LL 3 fibre-optic cable (sender fibre)
- 2 Receiver, installation of LL 3 fibre-optic cable (receiver fibre)
- 3 Protective hood, can be raised at both ends
- 4 Mounting bracket, included with delivery (see Accessories)
- 5 Connector
- 6 Indication of correct fibre-optic cable mounting
- 7 Indicator LED orange: lights up when switching output is active
- 8 LED signal strength indicator green, lights up when light received < 0.9 or > 1.1 (switching threshold = 1)
- 9 Sensitivity scale 270°
- 10 Sensitivity control (10 revolutions)
- 11 Selector switch for OFF delay: "OFF DLY" (=ON) / "OFF", 40 ms fixed
- 12 Selector switch: "L.ON" (light switching) / "D.ON" (dark switching)



Connection type

WLL170-2N132	WLL170-2N330	WLL170-2N430
WLL170-2P132	WLL170-2P330	WLL170-2P430

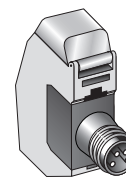
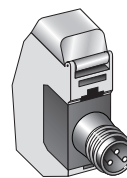
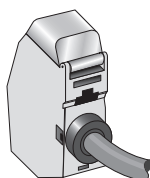

3 x 0.2 mm²

M8, 3-pin

M8, 4-pin

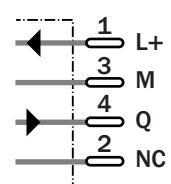
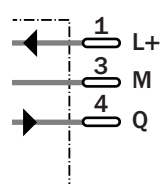
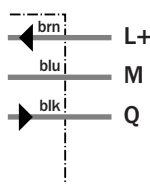

See chapter Accessories

Connector, M8, 3-pin
Connector, M8, 4-pin
Fibre-optic cable
Tip adapters
Mounting systems

Technical data		WLL170-2	N132	N330	N430	P132	P330	P430				
Operating distance	0 ... 160 mm ¹⁾											
Fibre-optic cable (proximity system):	LL3-DK06											
Adjustment of operating distance	Poti, 10 revolutions ²⁾											
Scanning range max. typ.	0 ... 4,000 mm											
Fibre-optic cable (through-beam system)	LL3-TB02 and tip adapter LL3-TA01											
Operating range, recommended	0 ... 700 mm											
Fibre-optic cable (through-beam system)	LL3-TB01											
Sensitivity adjustment	Poti, 10 revolutions ²⁾											
Light source, light type	LED, red light, 660 nm ³⁾											
Light spot diameter	Depends on scanning range											
Angle of dispersion	Approx. 65° see LL 3 fibre-optic data											
Supply voltage V_s	10 ... 30 V DC ⁴⁾											
Residual ripple	10 % ⁵⁾											
Power consumption	≤ 30 mA ⁶⁾											
Switching outputs	NPN: open collector: Q											
	PNP: open collector: Q											
Switching mode	Light/dark switching, switchable											
Output current I _a max	≤ 100 mA											
Response time	≤ 0,25 ms ⁷⁾											
Switching frequency	2,000 Hz ⁹⁾											
Time delay	40 ms fix, selectable by sliding switch											
Time type	Off delay t _{OFF}											
Connection type	Cable, Ø 3.8 mm, PVC, 2 m ⁹⁾											
	Connector, M8, 3-pin											
	Connector, M8, 4-pin											
VDE protection class	◆											
Circuit protection	V _s connections reverse-polarity protected / In-/outputs short-circuit protected / Interference pulse suppression / Outputs overcurrent and short-circuit protected											
Enclosure rating	IP 66 ¹⁰⁾											
Ambient temperature operation	-25 °C ... +55 °C											
Ambient temperature storage	-40 °C ... +70 °C											
Weight	Approx. 70 g											
Housing material	ABS/PC											

¹⁾ Object with 90 % remission (based on standard white to DIN 5033)

²⁾ Sensitivity scale 270°

³⁾ Average service life 100,000 h at

T_a = +25°C

⁴⁾ Limit values

⁵⁾ may not exceed or fall short of V_s

tolerances

⁶⁾ without load

⁷⁾ Signal transit time with resistive load

⁸⁾ with light/dark ratio 1:1

⁹⁾ do not bend below 0 °C

¹⁰⁾ with correctly attached fibre-optic cable LL 3 and closed protection hood

Function diagram for WLL 170-2

■ WLL 170-2

Orange LED display: lights up when switching output Q is active. Dependent on setting of light/dark selector switch.

Green LED display: lights up when light received is < 0.9 or > 1.1 (based on the switching threshold Q, switching threshold = 1).

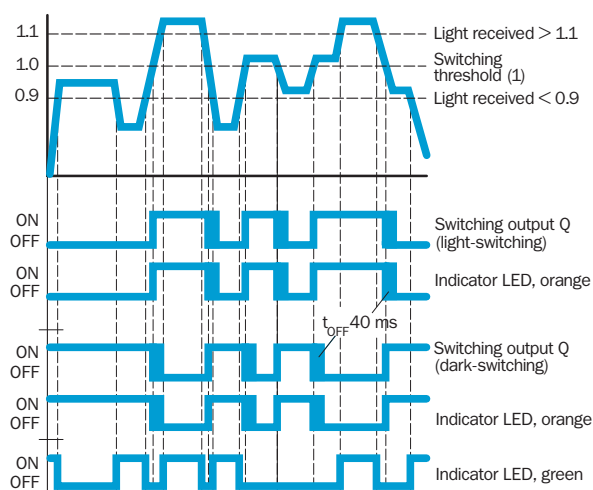

Ordering information

Type	Order no.
WLL170-2N132	6 029 515
WLL170-2N330	6 029 517
WLL170-2N430	6 029 518
WLL170-2P132	6 029 511
WLL170-2P330	6 029 513
WLL170-2P430	6 029 514