

TF 600



Telcordia GR-1089 · 600 VAC · Time-Lag T



Description

- Directly solderable on printed circuit boards

Standards

- IEC 60127-4
- UL 248-14
- CSA C22.2 no. 248.14
- Telcordia GR-1089
- UL 60950 / IEC 60950
- ITU-T K.20 and K.21
- TIA-968-A

Approvals

- UL File Number: E41599

Applications

- Twisted pair telecom ports requiring Telcordia GR-1089 / TIA-968-A / ITU-T / UL 60950 / IEC 60950 compliance
- see following pages

References

[General Product Information](#)

Time-Current Curves see last page

[Packaging Details](#)

Weblinks

Approvals: <http://www.schurter.com/approvals>

RoHS: <http://www.schurter.com/rohs>

Technical Data

Rated Voltage	600 VAC
Rated Current	0.5 - 2 A
Breaking Capacity	60 A
Characteristic	Time-Lag T
Mounting	PCB,SMT
Admissible Ambient Air Temp.	-55 °C to 125 °C
Climatic Category	55/125/21 acc. to IEC 60068-1
Material: Housing	Ceramic
Material: Terminals	Tin-Plated Copper Alloy
Unit Weight	0.23 g
Stock Conditions	0 °C to 60 °C, max. 70% r.h.
Product Marking	 , Type, Current Rating, Characteristic

Soldering Methods	Reflow
Solderability	245 °C / 3 sec acc. to IEC 60068-2-58, Test Td
Resistance to Soldering Heat	260 °C / 10 sec acc. to IEC 60068-2-58, Test Td
Flammability	min. UL 94V-1 (acc. to EIA/IS-722, Test 4.12)

Dimensions

Length  10.1 mm

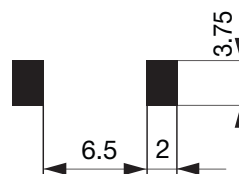
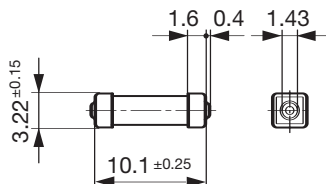

Solder pads reflow soldering

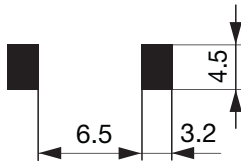
TF 600

Solder pads wave soldering

Pre-Arcing Time

Rated Current In	1.0 x In min.	2.5 x In min.	2.5 x In max
0.5 A - 2 A	4 h	1 s	120 s

Variants

Order Number	Rated Current [A]	Rated Voltage [V]	Voltage Drop 1.0 In typ [mV]	Cold Resistance typ 10.0 In typ [mΩ]	Melting I ² t 10.0 In typ [A ² s]
2000.0010.xx	0.5	600	107	210	1.14
2000.0011.xx	1.25	600	94	73.2	21.4
2000.0012.xx	2	600	55	27.8	22.3

1) 60 A @ 600 VAC , p.f. = 1.0 / 60 A @ 125 VDC

Packaging Unit

.xx = .11 Plastic Bag (100 pcs.)
 .xx = .24 Blister Tape 33 cm Reel (2000 pcs.)