

281/556/557 Series Thru-Hole Circuit Board Mount Holders for Micro™/TR-3 Fuses



Note: These products are shipped without fuse device

Product Characteristics				
	281 Series Vertical	281 Series Horizontal	556 Series Vertical	557 Series Horizontal
Compatible Fuses	MICRO™/TR3®			
Description	Thru-hole circuit board mount holders designed for Littelfuse MICRO™/TR3 type and other fuse series with .025" diameter leads rated to 5 amps			
Electrical	Rated at 5A / 1.6W to 125 volts.			
Mounting Method	PC Board Thru-Hole @ 5.08 hole spacing			
Mount Color & Direction	White Vertical	White Horizontal	Black Vertical	Black Horizontal
Molded Part Specs	White Thermoplastic UL 94V0 PBT		Black Thermoplastic UL 94V0	
Metal Parts and Terminals	Copper Alloy with options Tin Plating (281008, 281010) or Silver Plating (281005, 281007)		Copper Alloy with Tin Plating	
Ambient Temperature	-40°C to +100°C.			
Unit Weight	0.41g	0.50g	0.42g	0.51g

Dimensions units in inch (mm)

0281 0005H, 0281 0008H White / Vertical Mount Devices

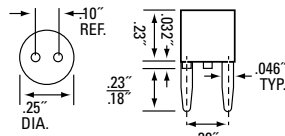

Circuit Board Mounting Detail

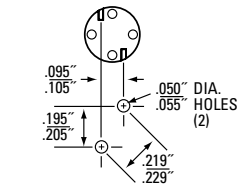

0281 0007H, 0281 0010H White / Horizontal Mount Devices

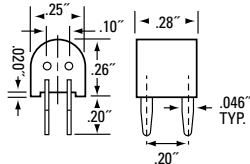

Circuit Board Mounting Detail

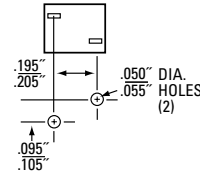

556 0000 0001 Black / Vertical Mount Devices

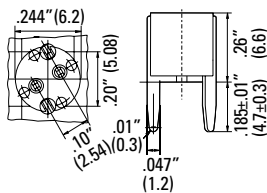

Circuit Board Mounting Detail

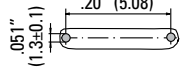

557 0000 0001 Black / Horizontal Mount Devices

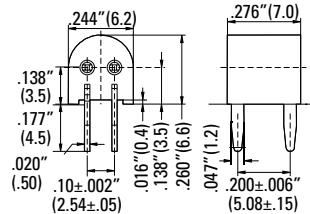

Circuit Board Mounting Detail

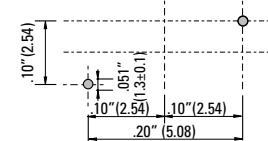

Note: Ensure proper fuseholder re-rating.

Agency Approvals

Agency	Agency File Number		
	281 Series	556 Series	557 Series
	E14721	N/A	N/A

Ordering Information

Ordering Number	Terminal Plating	Mount Color	Mount Direction	Packaging
0281 0005 H	Silver ¹	White	Vertical	100 (Bulk pack)
0281 0008 H	Tin ¹	White	Vertical	100 (Bulk pack)
0281 0007 H	Silver ¹	White	Horizontal	100 (Bulk pack)
0281 0010 H	Tin ¹	White	Horizontal	100 (Bulk pack)
556 0000 0001*	Tin	Black	Vertical	1000 (Bulk pack)
557 0000 0001*	Tin	Black	Horizontal	1000 (Bulk pack)

1. UL recognized.

* RoHs compliant.

Note: 0281 Series have Glow Wire

Additional Information



Datasheet



Resources



Samples