

REFERENCE DATA

1. Max. switching power (AC resistive load)

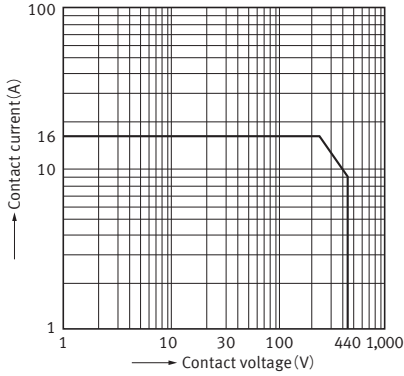

2. Max. switching power (DC resistive load)

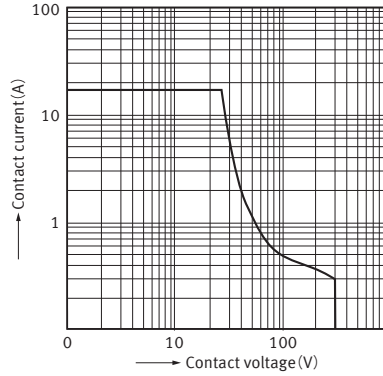

3. Coil temperature rise

Tested sample : ALZ11F12, 5 pcs.
Measured portion : Coil inside
Contact current : 0A, 16A

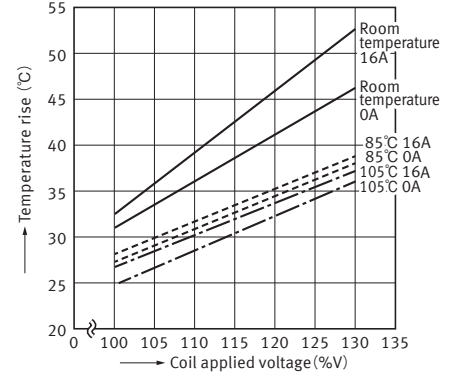

DIMENSIONS (mm)

CAD The CAD data of the products with a "CAD" mark can be downloaded from our Website.

1 Form A type

CAD



External dimensions

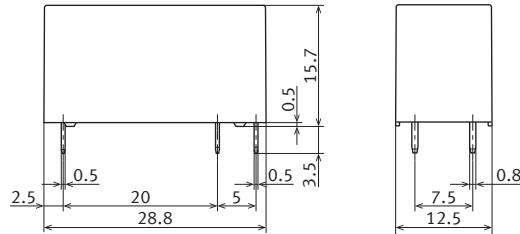

PC board pattern

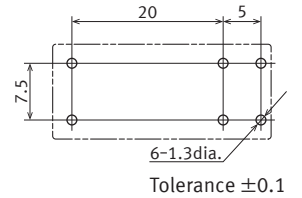

Schematic (Bottom view)

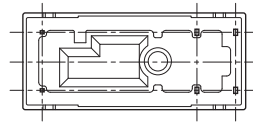
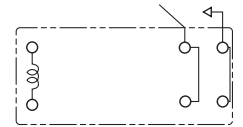

General tolerance
Less than 1mm : ± 0.1
Min. 1mm less than 3mm : ± 0.2
Min. 3mm : ± 0.3

2. 1 Form C type

CAD



External dimensions

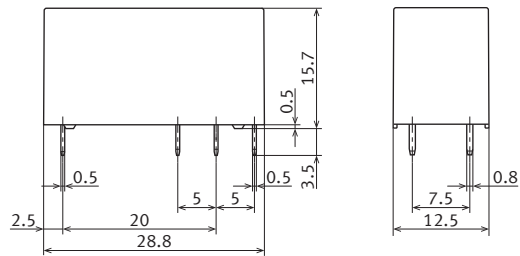

PC board pattern

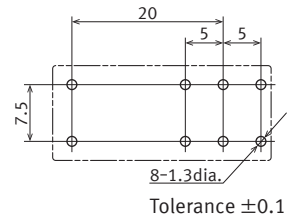

Schematic (Bottom view)

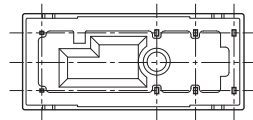
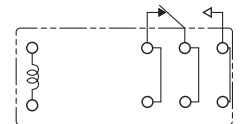

General tolerance
Less than 1mm : ± 0.1
Min. 1mm less than 3mm : ± 0.2
Min. 3mm : ± 0.3

SAFETY STANDARDS

UL/C-UL (Recognized)		VDE (Certified)		TV rating (UL/CSA)	
File No.	Contact rating	File No.	Contact rating	File No.	Rating
E43149	16A 277V AC, 34.8LRA/7.2FLA/120V AC, 15LRA/3FLA/120V AC 10LRA/3FLA 240V AC, 20A 240V AC (N.O. only) 16A 30V DC, 25A 240V AC, 15A 240V AC Resistive load 105°C (N.O. only)	40000380	16A 250V AC ($\cos\phi = 1.0$)	C-UL E43149	TV-5

* CSA standard: Certified by C-UL

NOTES

1. For cautions for use, please read

“GENERAL APPLICATION
GUIDELINES” on page B-1.

2. Electrical life (Sealed type)

In order to obtain the full rated life cycles,
the relay should be properly vented by
removing the vent nib after the soldering/
washing process.

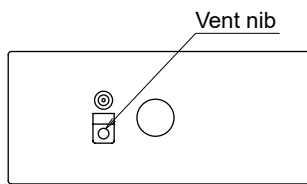

Please refer to "**the latest product specifications**"
when designing your product.

•Requests to customers:

<https://industrial.panasonic.com/ac/e/salespolicies/>