

40 SERIES

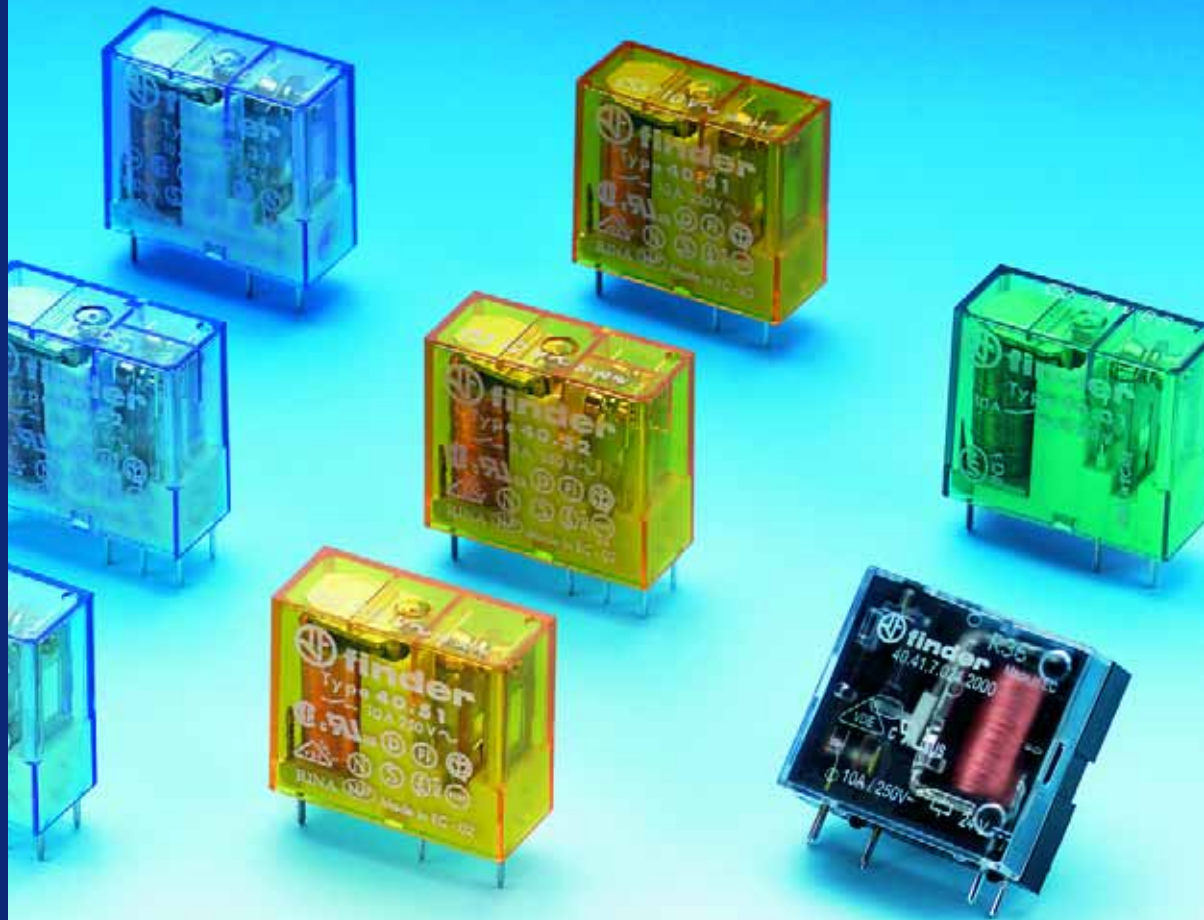

NEW

Miniature PCB relays

Features

- 1 & 2 Pole relay range**
 40.31 - 1 Pole 10 A (3.5 mm pin pitch)
 40.51 - 1 Pole 10 A (5 mm pin pitch)
 40.52 - 2 Pole 8 A (5 mm pin pitch)

PCB mount
 - direct or via PCB socket

35 mm rail mount
 - via screw and screwless sockets

- DC coils (standard or sensitive) & AC coils
- Cadmium Free contact material
- 8 mm, 6 kV (1.2/50 μs) isolation, coil-contacts
- UL Listed (certain relay/socket combinations)
- Flux proof: RT II standard, (RT III option)
- 95 series sockets, coil EMC suppression and timer accessories

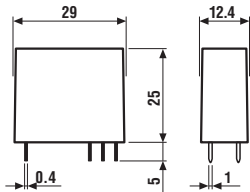

40.31



- 3.5 mm contact pin pitch
- 1 Pole 10 A
- PCB or 95 series sockets

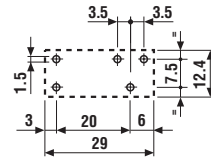
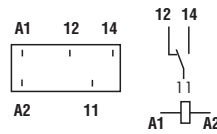

Copper side view

40.51



- 5 mm contact pin pitch
- 1 Pole 10 A
- PCB or 95 series sockets

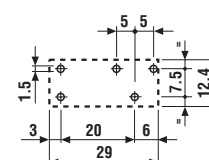
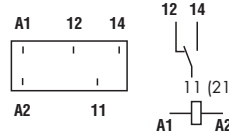

Copper side view

40.52



- 5 mm contact pin pitch
- 2 Pole 8 A
- PCB or 95 series sockets

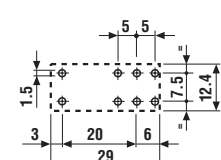
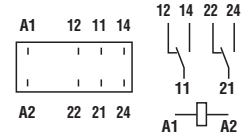

Copper side view

| Contact specification | | | | |
|--|-----------------|---|---|---|
| Contact configuration | | 1 CO (SPDT) | 1 CO (SPDT) | 2 CO (DPDT) |
| Rated current/Maximum peak current | A | 10/20 | 10/20 | 8/15 |
| Rated voltage/Maximum switching voltage | V AC | 250/400 | 250/400 | 250/250 |
| Rated load AC1 | VA | 2,500 | 2,500 | 2,000 |
| Rated load AC15 (230 V AC) | VA | 500 | 500 | 400 |
| Single phase motor rating (230 V AC) | kW | 0.37 | 0.37 | 0.3 |
| Breaking capacity DC1: 30/110/220 V | A | 10/0.3/0.12 | 10/0.3/0.12 | 8/0.3/0.12 |
| Minimum switching load | mW (V/mA) | 300 (5/5) | 300 (5/5) | 300 (5/5) |
| Standard contact material | | AgNi | AgNi | AgNi |
| Coil specification | | | | |
| Nominal voltage (U _N) | V AC (50/60 Hz) | 6 - 12 - 24 - 48 - 60 - 110 - 120 - 230 - 240 | | |
| | V DC | 5 - 6 - 7 - 9 - 12 - 14 - 18 - 21 - 24 - 28 - 36 - 48 - 60 - 90 - 110 - 125 | | |
| Rated power AC/DC/sens. DC | VA (50 Hz)/W/W | 1.2/0.65/0.5 | 1.2/0.65/0.5 | 1.2/0.65/0.5 |
| Operating range | AC | (0.8...1.1)U _N | (0.8...1.1)U _N | (0.8...1.1)U _N |
| | DC/sens. DC | (0.73...1.5)U _N /(0.73...1.75)U _N | (0.73...1.5)U _N /(0.73...1.75)U _N | (0.73...1.5)U _N /(0.73...1.75)U _N |
| Holding voltage | AC/DC | 0.8 U _N / 0.4 U _N | 0.8 U _N / 0.4 U _N | 0.8 U _N / 0.4 U _N |
| Must drop-out voltage | AC/DC | 0.2 U _N / 0.1 U _N | 0.2 U _N / 0.1 U _N | 0.2 U _N / 0.1 U _N |
| Technical data | | | | |
| Mechanical life AC/DC | cycles | 10 · 10 ⁶ /20 · 10 ⁶ | 10 · 10 ⁶ /20 · 10 ⁶ | 10 · 10 ⁶ /20 · 10 ⁶ |
| Electrical life at rated load AC1 | cycles | 200 · 10 ³ | 200 · 10 ³ | 100 · 10 ³ |
| Operate/release time | ms | 7/3 - (12/4 sensitive) | 7/3 - (12/4 sensitive) | 7/3 - (12/4 sensitive) |
| Insulation between coil and contacts (1.2/50 μs) | kV | 6 (8 mm) | 6 (8 mm) | 6 (8 mm) |
| Dielectric strength between open contacts | V AC | 1,000 | 1,000 | 1,000 |
| Ambient temperature range | °C | -40...+85 | -40...+85 | -40...+85 |
| Environmental protection | | RT II | RT II | RT II |
| Approvals (according to type) | | | | |