

Features

40.61 - 1 Pole 16 A (5 mm pin pitch)
40.xx.6 - Bistable versions of the 40.31, 40.51, 40.52 & 40.61 relays

PCB mount

- direct or via PCB socket

35 mm rail mount

- via screw and screwless sockets

- DC coils & AC coils
- Cadmium Free option available
- 8 mm, 6 kV (1.2/50 μs) isolation, coil-contacts
- UL Listed (certain 40.61 relay/socket combinations)
- Flux proof: RT II standard, (RT III option)
- 95 series sockets, coil suppression and timer accessories

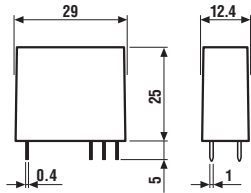

* With the AgSnO₂ material the maximum peak current is 120 A - 5 ms on normally open contact.

40.61



- 5 mm contact pin pitch
- 1 Pole 16 A
- PCB or 95 series sockets

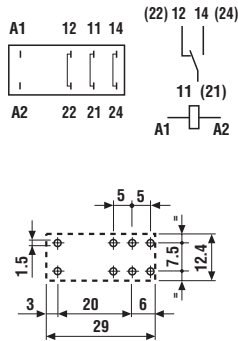

Copper side view

40.xx.6



- Bistable (single coil) versions of 40.31/51/52/61
- PCB or 95 series sockets

Bistable version (1 coil) types:

- 40.31.6...
- 40.51.6...
- 40.52.6...
- 40.61.6...

For wiring diagrams see page 8

Contact specification

| | | |
|--|-------------|-------------|
| Contact configuration | 1 CO (SPDT) | |
| Rated current/Maximum peak current | A | 16/30* |
| Rated voltage/Maximum switching voltage V AC | | 250/400 |
| Rated load AC1 | VA | 4,000 |
| Rated load AC15 (230 V AC) | VA | 750 |
| Single phase motor rating (230 V AC) | kW | 0.55 |
| Breaking capacity DC1: 30/110/220 V | A | 16/0.3/0.12 |
| Minimum switching load | mW (V/mA) | 500 (10/5) |
| Standard contact material | | AgCdO |

Coil specification

| | | | |
|-----------------------------------|-----------------|---|------------------------------|
| Nominal voltage (U _N) | V AC (50/60 Hz) | 6 - 12 - 24 - 48 - 60 - 110 - 120 - 230 - 240 | 5 - 6 - 12 - 24 - 48 - 110 |
| | V DC | ** See below | 5 - 6 - 12 - 24 - 48 - 110 |
| Rated power AC/DC/sens. DC | VA (50 Hz)/W/W | 1.2/0.65/0.5 | 1.0/1.0/— |
| Operating range | AC | (0.8...1.1)U _N | (0.8...1.1)U _N |
| | DC/sens. DC | (0.73...1.5)U _N /(0.8...1.5)U _N | (0.8...1.1)U _N /— |
| Holding voltage | AC/DC | 0.8 U _N / 0.4 U _N | — |
| Must drop-out voltage | AC/DC | 0.2 U _N / 0.1 U _N | — |

** Nominal voltage (U_N):
 5 - 6 - 7 - 9 - 12 - 14 - 18 - 21 -
 24 - 28 - 36 - 48 - 60 - 90 -
 110 - 125 V DC

Technical data

| | | | |
|--|--------|--|-----------------------|
| Mechanical life AC/DC | cycles | 10 · 10 ⁶ /20 · 10 ⁶ | See relays |
| Electrical life at rated load AC1 | cycles | 100 · 10 ³ | 40.31 |
| Operate/release time | ms | 7/3 - (12/4 sensitive) | 40.51 |
| Insulation between coil and contacts (1.2/50 μs) | kV | 6 (8 mm) | 40.52 |
| Dielectric strength between open contacts | V AC | 1,000 | 40.61 |
| Ambient temperature range | °C | -40...+85 | Min. impulse duration |
| Environmental protection | | RT II | ≥ 20 ms |

Approvals (according to type)



Features

1 Pole relay range

- 40.11 - 1 Pole 10 A (Flat pack)
- 40.11-2016 - 1 Pole 16 A (Flat pack)
- 40.41 - 1 Pole 10 A (Vertical)

PCB mount

- direct or via PCB socket (40.41 version)

- DC coils
- Cadmium Free option available
- 8 mm, 6 kV (1.2/50 μ s) isolation, coil-contacts
- 40.41 - NO version available

40.11



- 1 Pole 10 A
- Flat pack
- PCB mount

40.11-2016



- 1 Pole 16 A
- Flat pack
- PCB mount

40.41



- 1 Pole 10 A
- Vertical
- PCB or 95 series socket

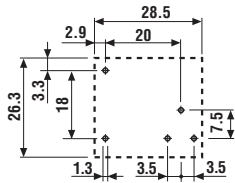
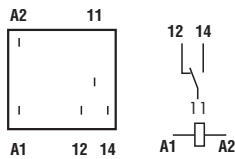
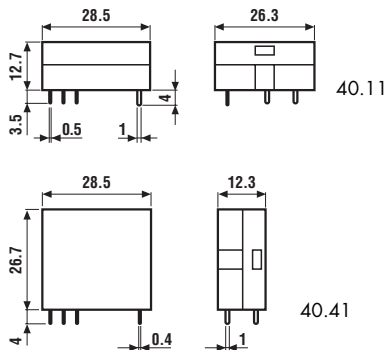

Copper side view

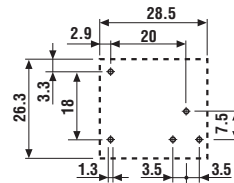
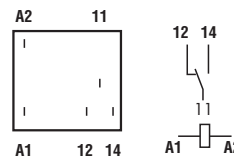

Copper side view

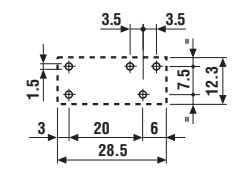
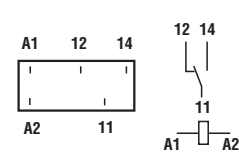

Copper side view

| Contact specification | | | | |
|---|-----------------|------------------------|------------------------|------------------------|
| Contact configuration | | 1 CO (SPDT) | 1 CO (SPDT) | 1 CO (SPDT) |
| Rated current/Maximum peak current | A | 10/20 | 16/30 | 10/20 |
| Rated voltage/Maximum switching voltage | V AC | 250/400 | 250/400 | 250/400 |
| Rated load AC1 | VA | 2,500 | 4,000 | 2,500 |
| Rated load AC15 (230 V AC) | VA | 500 | 750 | 500 |
| Single phase motor rating (230 V AC) | kW | 0.37 | 0.55 | 0.37 |
| Breaking capacity DC1: 30/110/220 V | A | 10/0.3/0.12 | 16/0.3/0.12 | 10/0.3/0.12 |
| Minimum switching load | mW (V/mA) | 300 (5/5) | 500 (10/5) | 300 (5/5) |
| Standard contact material | | AgCdO | AgCdO | AgCdO |
| Coil specification | | | | |
| Nominal voltage (U_N) | V AC (50/60 Hz) | — | — | — |
| | V DC | 6 - 12 - 24 - 48 - 60 | 6 - 12 - 24 - 48 | 6 - 12 - 24 - 48 - 60 |
| Rated power AC/DC/sens. DC | VA (50 Hz)/W/W | —/—/0.5 | —/—/0.5 | —/—/0.5 |
| Operating range | AC | — | — | — |
| | DC/sens. DC | —/(0.73...1.75) U_N | —/(0.73...1.5) U_N | —/(0.73...1.75) U_N |
| Holding voltage | AC/DC | —/0.4 U_N | —/0.4 U_N | —/0.4 U_N |
| Must drop-out voltage | AC/DC | —/0.1 U_N | —/0.1 U_N | —/0.1 U_N |
| Technical data | | | | |
| Mechanical life AC/DC | cycles | —/20 · 10 ⁶ | —/20 · 10 ⁶ | —/20 · 10 ⁶ |
| Electrical life at rated load AC1 | cycles | 200 · 10 ³ | 50 · 10 ³ | 200 · 10 ³ |
| Operate/release time | ms | 12/4 | 12/4 | 12/4 |
| Insulation between coil and contacts (1.2/50 μ s) | kV | 6 (8 mm) | 6 (8 mm) | 6 (8 mm) |
| Dielectric strength between open contacts | V AC | 1,000 | 1,000 | 1,000 |
| Ambient temperature range | °C | −40...+70 | −40...+70 | −40...+70 |
| Environmental protection | | RT I | RT I | RT I |

Approvals (according to type)

