

| Technical specifications          |   | WT150- | N162 | N460 | P162 | P460 |  |  |  |  |  |  |
|-----------------------------------|---|--------|------|------|------|------|--|--|--|--|--|--|
| Scanning distance typ. max.       | 2 ... 100 mm <sup>1)</sup>  |        |      |      |      |      |  |  |  |  |  |  |
| Adjustment of operating distance  | Potentiometer, 5 revolutions  |        |      |      |      |      |  |  |  |  |  |  |
| Light source, light type          | LED, Red light <sup>2)</sup>  |        |      |      |      |      |  |  |  |  |  |  |
| Light spot diameter               | Approx. 4 mm at 40 mm distance  |        |      |      |      |      |  |  |  |  |  |  |
| Angle of dispersion               | Ca. 5 °   |        |      |      |      |      |  |  |  |  |  |  |
| Supply voltage V <sub>s</sub>     | DC 10 ... 30 V <sup>3)</sup>  |        |      |      |      |      |  |  |  |  |  |  |
| Ripple                            | ± 10 % <sup>4)</sup>  |        |      |      |      |      |  |  |  |  |  |  |
| Power consumption                 | ≤ 20 mA <sup>5)</sup>   |        |      |      |      |      |  |  |  |  |  |  |
| Switching outputs                 | NPN: open collector: Q<br>PNP: open collector: Q  |        |      |      |      |      |  |  |  |  |  |  |
| Switching mode                    | Light-/dark-switching via L/D control cable<br>+V <sub>s</sub> = light-switching<br>0 V = dark-switching <sup>6)</sup>  |        |      |      |      |      |  |  |  |  |  |  |
| Output current I <sub>a</sub> max | ≤ 100 mA  |        |      |      |      |      |  |  |  |  |  |  |
| Response time                     | ≤ 0,5 ms <sup>7)</sup>  |        |      |      |      |      |  |  |  |  |  |  |
| Switching frequency               | 1,000 Hz <sup>8)</sup>  |        |      |      |      |      |  |  |  |  |  |  |
| Connection type                   | Cable, PVC, 2 m <sup>9)</sup>   |        |      |      |      |      |  |  |  |  |  |  |
|                                   | Connector, M8, 4-pin  |        |      |      |      |      |  |  |  |  |  |  |
| VDE protection class              | □ <sup>10)</sup>  |        |      |      |      |      |  |  |  |  |  |  |
| Circuit protection                | V <sub>s</sub> connections reverse-polarity protected<br>/ In-/outputs short-circuit protected<br>/ Interference suppression / Outputs<br>overcurrent and short-circuit protected |        |      |      |      |      |  |  |  |  |  |  |
| Enclosure rating                  | IP 67   |        |      |      |      |      |  |  |  |  |  |  |
| Ambient temperature operation     | -25 °C ... +55 °C   |        |      |      |      |      |  |  |  |  |  |  |
| Ambient temperature storage       | -40 °C ... +75 °C   |        |      |      |      |      |  |  |  |  |  |  |
| Weight                            | Ca. 44 g<br>Ca. 7 g   |        |      |      |      |      |  |  |  |  |  |  |
| Housing material                  | ABS, PC   |        |      |      |      |      |  |  |  |  |  |  |
| Included with delivery            | Mounting bracket BEF-W150-A   |        |      |      |      |      |  |  |  |  |  |  |

1) Object with 90 % remission (based on standard white to DIN 5033). Scanning distance control set to MAX  
 2) Average service life 100,000 h  
 3) at T<sub>a</sub> = +25 °C  
 4) Limit values  
 5) Without load  
 6) Control wire must be connected  
 7) Signal transit time with resistive load  
 8) With light/dark ratio 1:1  
 9) Do not bend below 0 °C  
 10) Reference voltage 50 V DC  
 12) Black = 6 % remission  
 Grey = 18 % remission  
 White = 90 % remission

**Scanning distance**

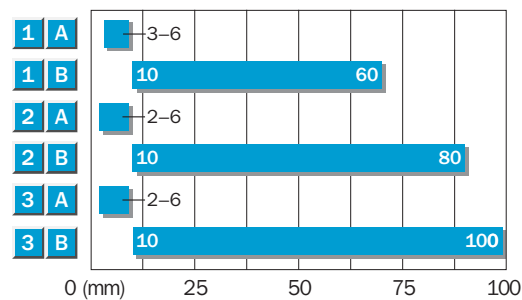

- 1 Scanning distance on black<sup>12)</sup>/white background
- 2 Scanning distance on grey<sup>12)</sup>/white background
- 3 Scanning distance on white<sup>12)</sup>/white background
- A Scanning distance control set to MIN
- B Scanning distance control set to MAX

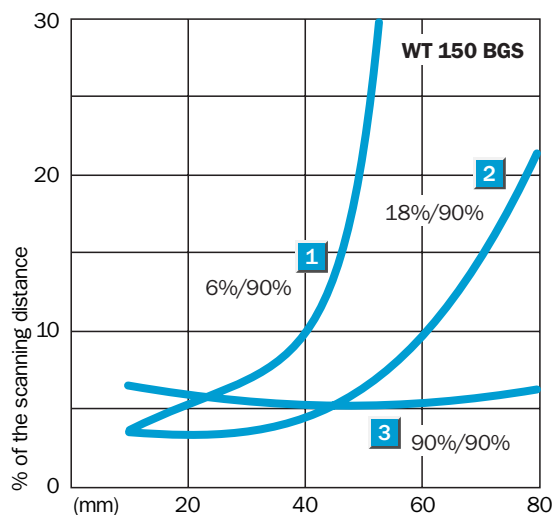

| Ordering information |             |
|----------------------|-------------|
| Type                 | Part Number |
| WT150-N162           | 6 011 045   |
| WT150-N460           | 6 011 047   |
| WT150-P162           | 6 011 048   |
| WT150-P460           | 6 011 050   |



**Scanning distance**  
**10 ... 250 mm**  
**Photoelectric proximity switch**

- Energetic photoelectric proximity switch for standard applications and simple contrast detection
- Adjustable switching point with sensitivity potentiometer

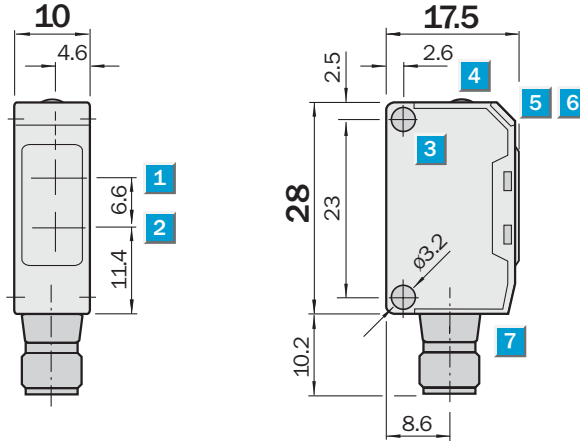
**Dimensional drawing**

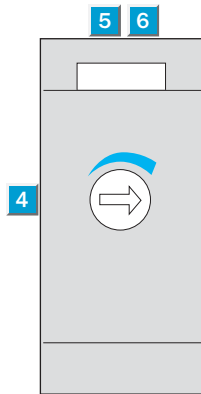

**Adjustments possible**



- 1 Optics centre, receiver
- 2 Optics centre, transmitter
- 3 Mounting hole  $\varnothing$  3.2 mm
- 4 Scanning distance adjustment 270°
- 5 LED indicator green: stability indicator
- 6 LED indicator orange: output active
- 7 Connector

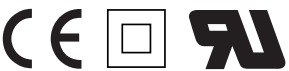

**Connection type**

|            |            |
|------------|------------|
| WT150-N132 | WT150-N430 |
| WT150-P132 | WT150-P430 |

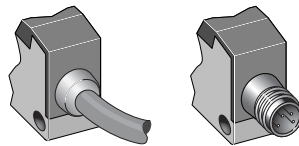

**Accessories**

|                      |
|----------------------|
| Connector, M8, 4-pin |
| Mounting systems     |

4 x 0.18 mm<sup>2</sup>      M8, 4-pin

