



AS-INTERFACE SAFETY AT WORK SLIMLINE S22.5F  
STANDARD IP20 2F-DI

### General technical data:

<b>Design of the product</b>		Safe SlimLine module S22,5F, 2F-DI
<b>Type</b>		2 inputs, safe
<b>I/O configuration</b>		0
<b>ID/ID2 code</b>		B/F
<b>Protocol / is supported / AS interface protocol</b>		Yes
<b>Design of the electrical connection / of the inputs and outputs</b>		screw terminal
<b>operating voltage</b>		
<ul style="list-style-type: none"> <li>according to AS-Interface specification</li> </ul>	V	26.5 ... 31.5
<b>AS interface / total current input / max</b>	mA	45
<b>Addressing</b>		front addressing socket
<b>Reference code</b>		
<ul style="list-style-type: none"> <li>according to DIN 40719 extended according to IEC 204-2 / according to IEC 750</li> <li>according to DIN EN 61346-2</li> </ul>		A
		A

### Inputs:

<b>Number of digital inputs / safety-related</b>		2
<b>Inputs</b>		
<ul style="list-style-type: none"> <li>sensors</li> <li>switching level High</li> </ul>		mechanical switching contact
		contact closed

• switching level Low		contact open
<b>Input current / at the digital input / for signal &lt;1&gt; / minimum</b>	mA	5

#### Outputs:

**Voltage type / of output voltages**

DC

#### Status display

- display of I/Os
- display of AS-Interface/diagnostics

yellow LED

green/red LED

#### Ambient conditions:

**Ambient temperature**

- during operating
- during storage

°C -25 ... +70

°C -40 ... +85

**Protection class IP**

IP20

#### Mechanical design:

**Width**

mm 22.5

**Height**

mm 90

**Depth**

mm 91

**Mounting type**

standard rail mounting/wall mounting

#### Certificates/approvals:

**AS-Interface certificate**

yes

**Approvals**

UL, CSA

**General Product Approval**

**Functional Safety /  
Safety of  
Machinery**

**Declaration of  
Conformity**



CSA



GOST



UL



VDE



EG-Konf.

**Shipping Approval**



ABS



BUREAU  
VERITAS



LRS



PRS



RINA



RMRS

**other**

[Confirmation](#)

[Declaration of  
Conformity](#)

[other](#)

[Environmental  
Confirmations](#)

#### Further information:

**Information- and Downloadcenter (Catalogs, Brochures,...)**

<http://www.siemens.com/industrial-controls/catalogs>

Industry Mall (Online ordering system)

<http://www.siemens.com/industrial-controls/mall>

CAX-Online-Generator

<http://www.siemens.com/cax>

Service&Support (Manuals, Certificates, Characteristics, FAQs,...)

<http://support.automation.siemens.com/WW/view/en/3RK1205-0BE00-0AA2/all>

Image database (product images, 2D dimension drawings, 3D models, device circuit diagrams, ...)

[http://www.automation.siemens.com/bilddb/cax\\_en.aspx?mlfb=3RK1205-0BE00-0AA2](http://www.automation.siemens.com/bilddb/cax_en.aspx?mlfb=3RK1205-0BE00-0AA2)

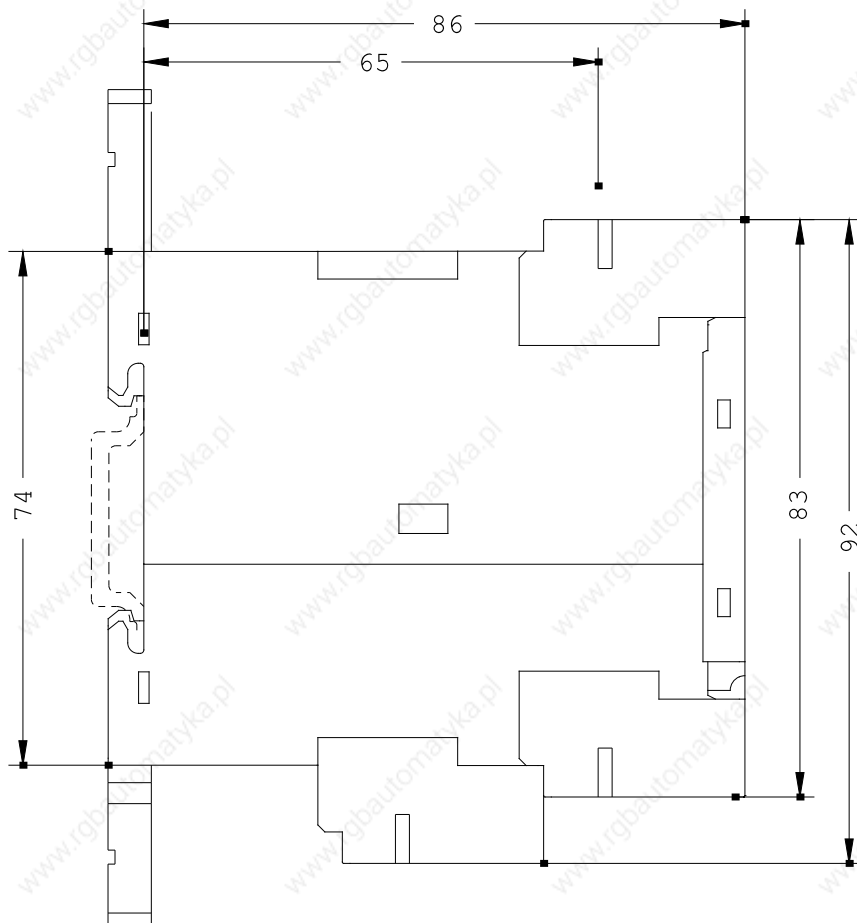
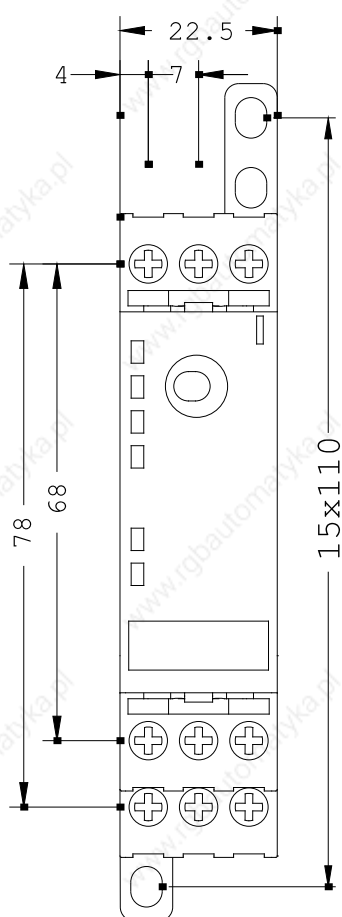

last change:

Jul 21, 2014