

4. Ambient temperature characteristics

Tested sample: PQ1a-24V

Contact carrying current: 5 A

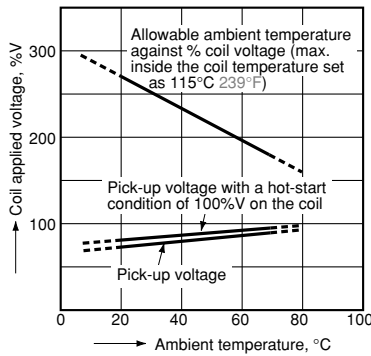

**DIMENSIONS** (mm inch)

The CAD data of the products with a **CAD Data** mark can be downloaded from: <http://industrial.panasonic.com/ac/e/>

**CAD Data**



External dimensions

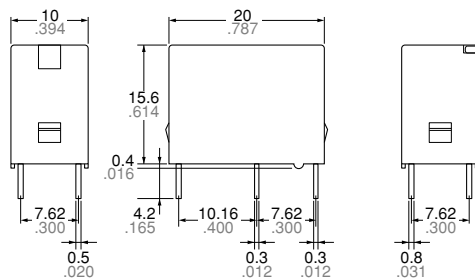

Schematic (Bottom view)

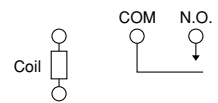

PC board pattern (Bottom view)

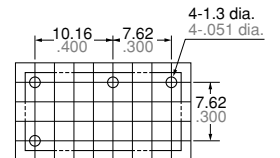

**Dimension:**

Less than 1mm .039inch:

Min. 1mm .039inch less than 5mm .197 inch:  $\pm 0.3 \pm 0.12$

Min. 5mm .197 inch:

**General tolerance**

$\pm 0.2 \pm 0.08$

$\pm 0.3 \pm 0.12$

$\pm 0.4 \pm 0.16$

Tolerance:  $\pm 0.1 \pm 0.04$

**SAFETY STANDARDS**

UL (Recognized)		CSA (Certified)		VDE (Certified)			
File No.	Contact rating	File No.	Contact rating	File No.	Contact rating	Temp.	Cycles
E43028	5A 277V AC	LR26550	5A 277V AC	40013088	5A 250V AC ( $\cos\phi=0.4$ )	70°C 158°F	10 <sup>4</sup>
	1/8HP 277V AC		1/8HP 277V AC		5A 30V DC (0ms)	70°C 158°F	10 <sup>4</sup>
	5A 30V DC		5A 30V DC		—	—	—
	0.3A 110V DC		0.3A 110V DC		—	—	—

**EN/IEC VDE Certified INSULATION CHARACTERISTIC (IEC61810-1)**

Item	Characteristic
Clearance/Creepage distance (IEC61810-1)	Min. 3.0mm/4.0mm
Category of protection (IEC61810-1)	RT III
Tracking resistance (IEC60112)	PTI 175
Insulation material group	III a
Over voltage category	III
Rated voltage	250V
Pollution degree	3
Type of insulation (Between contact and coil)	Basic insulation
Type of insulation (Between open contacts)	Micro disconnection

## NOTES

### 1. For cautions for use, please read “GENERAL APPLICATION GUIDELINES”.

#### Note about relay installation orientation

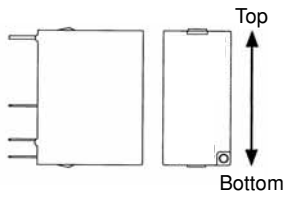

When installing with the relay terminals parallel to the ground, the contact terminals at the bottom and the coil terminals at the top, component friction will occur after numerous switching actions or due to vibration in the non-excitation state.

Since this may cause the relay to stop functioning when the pick-up voltage increases even if the nominal voltage is applied, please do not install using this orientation.