

# SIEMENS

## Product data sheet

**3RU1146-4JD0**

Abb. ähnlich / similar picture

OVERLOAD RELAY 45...63 A FOR MOTOR  
PROTECTION SIZE S3,  
CLASS 10 FOR CONT. MOUNTING MAIN CIRC.:  
SCREW CONN. AUX. CIRC.: SPRING-LOADED  
TERM. MANUAL-AUTOMATIC-RESET

### General technical details:

Operating current / of the fuse link / rated value	125 A
Adjustable response current / of the current-dependent overload release / initial value	45 A
Adjustable response current / of the current-dependent overload release / final value	63 A
Service power / for three-phase servomotors / rated value	30 kW
Number of NC contacts / for auxiliary contact	1
Number of NO contacts / for auxiliary contact	1
Number of change-over switches / for auxiliary contact	0
Type of assignment	2
Type of protection	DMT 98 ATEX G 001

### Mechanical design:

Design of the electrical connection / for main current circuit	screw-type terminals
Design of the electrical connection / for auxiliary and control current circuit	Cage Clamp terminals
Size of the contactor / can be combined / company-specific	S3

Type of fixing/fixation	direct mounting
Size of overload relay	S3
Ambient conditions:	
Protection class IP	IP20

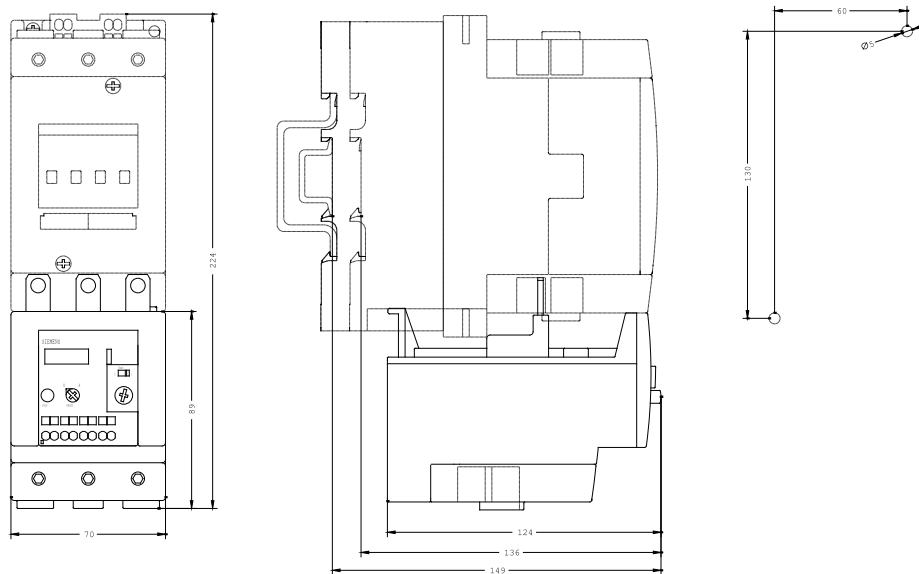

last change:

10/31/2006

**Technical Assistance:**

Telephone: +49 (0) 911-895-5900 (8<sup>00</sup> - 17<sup>00</sup> CET)

Fax: +49 (0) 911-895-5907

E-Mail: [technical-assistance@siemens.com](mailto:technical-assistance@siemens.com)

Internet: [www.siemens.de/lowvoltage/technical-assistance](http://www.siemens.de/lowvoltage/technical-assistance)