

# W 9-2: A Versatile, Complete and Compact Series



Depending on the job, the most suitable sensor can be selected from the W 9-2 series.

Overview of the sensors:  
 WT 9-2, with adjustable background suppression, max. scanning distance 250 mm,  
 WT 9-2, energetic, max. scanning distance 450 mm,  
 WT 9-2, V model, max. scanning distance 20 mm,  
 WL 9-2, basic model, max. scanning range 4 m,  
 WL 9-2, Teach-In model, max. scanning range 4 m,  
 WL 9-2, focus, max. scanning range 0.4 m.

**T**he W 9-2 series is as versatile as the tasks in automation. The standardized, compact housing model makes it possible to use high-performance sensors that operate reliably even in cramped mounting conditions. All W 9-2 models have red light transmitters as a standard feature. The sensor can be aligned on the object quickly and precisely using the visible light spot. In the models with Teach-In function, the sensor optimizes its sensitivity automatically to the given operating conditions at the push of a button.

There are multifaceted applications in the targeted main branches thanks to this great variety of products:

- Storage and handling engineering
- Packaging industry
- Electronics industry
- Elevator construction.

	<b>Photoelectric proximity switches HGA</b>
	<b>Photoelectric proximity switches ener.</b>
	<b>Photoelectric proximity switches V</b>
	<b>Photoelectric reflex switches</b>



**Scanning distance**  
 30 ... 250 mm  
**Photoelectric proximity switch**

- LED light source, visible red light
- Background suppression
- Scanning distance adjustable
- Switching frequency 1500/s
- Outputs short-circuit protected

### Dimension illustration

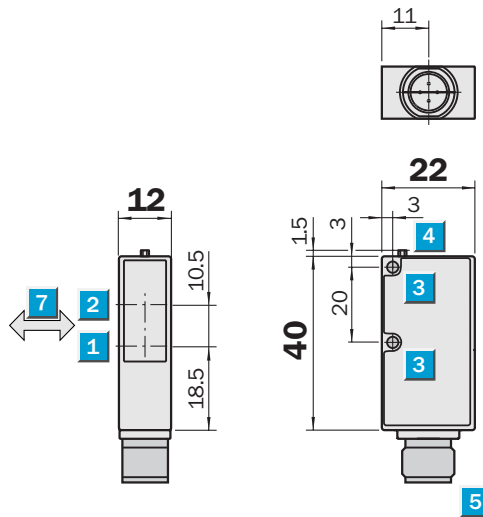

### Setting options

WT 9-2P130	WT 9-2P330
WT 9-2P430	WT 9-2P630
WT 9-2N130	
WT 9-2N430	

- 1 Axis of the sender optics
- 2 Axis of the receiver optics
- 3 Mounting hole  $\varnothing$  3.2 mm
- 4 LED signal strength indicator
- 5 Plug M 12 or M 8, 4 pin, 2 m connection cable or 120 mm cable with plug M 12, 4 pin
- 6 Scanning distance adjuster
- 7 Standard direction of the material to be scanned

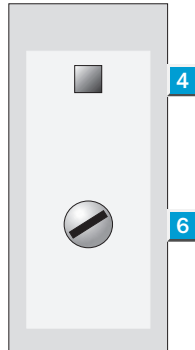

### Connection type

WT 9-2P430	WT 9-2P330	WT 9-2P130	WT 9-2P630
WT 9-2N430		WT 9-2N130	

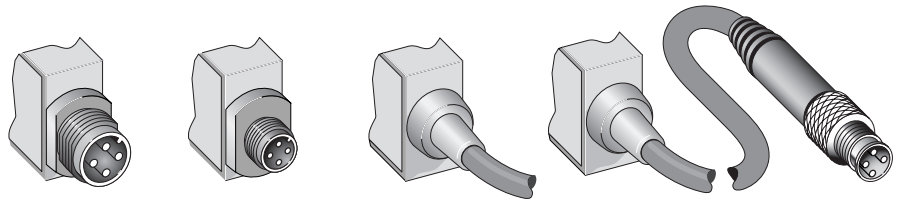

#### 4 pin, M 12

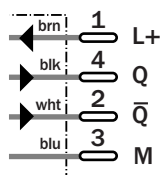

#### 4 pin, M 8

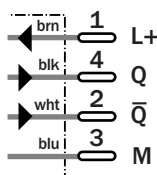

#### 4 x 0,14 mm<sup>2</sup>

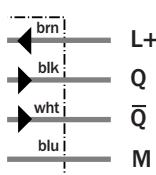

#### 4 pin, M 12 with 120 mm cable

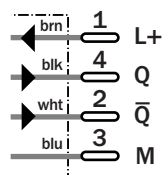

### Accessories

- Mounting bracket
- Cable receptacles
- Adapter plate

