



## SOCKETS FOR C3 RELAYS

- Built in retaining clip
- Removable label marking facility
- Coding ring compatible
- One or two level terminals
- DIN rail, solder tag or PCB mount



### S3-B One level. Integrated clip and marking label

Accepts the exclusive Releco coding ring for coding both the relay and base. DIN rail or panel mountable. Removable label. EN/DIN and sequential numbering. According to EN60947

#### Wiring diagram

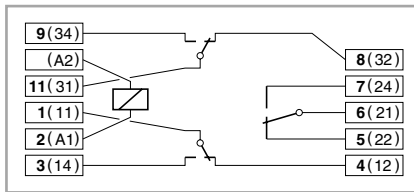

#### Specifications

Nominal load 10A/250V  
 Dielectric strength (adjacent screws) 2,5 KV  
 Dielectric strength (screws/rail) 2,5 KV  
 Max. screw torque 1,2 Nm  
 Screw dimensions M3, Pozi  
 Wire in-lets capacity:  
 Solid wire 4 mm<sup>2</sup> or 2 x 2,25 mm<sup>2</sup>  
 Multi-core 22 - 14 AWG

### S3-S Two level. Integrated clip and marking label

Accepts the exclusive Releco coding ring for coding both the relay and base. DIN rail or panel mountable. Removable label. EN/DIN and sequential numbering. According to EN60947

#### Wiring diagram

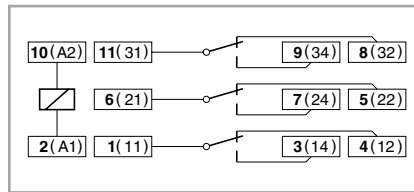

#### Specifications

Nominal load 10A/250V  
 Dielectric strength (adjacent screws) 2,5 KV  
 Dielectric strength (screws/rail) 2,5 KV  
 Max. screw torque 1,2 Nm  
 Screw dimensions M3, Pozi  
 Wire in-lets capacity:  
 Solid wire 4 mm<sup>2</sup> or 2 x 2,25 mm<sup>2</sup>  
 Multi-core 22 - 14 AWG

### S3-L S3-PO 8 pin, solder and printed circuit tags

S3-L Flange panel mountable.

S3-PO Printed circuit tags with flange.

#### Printed circuit lay-out

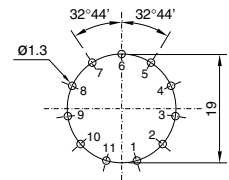

#### Specifications

Nominal load 10 A/250 V  
 Dielectric strength (adjacent pin) 2,5 KV  
 Hard brass, tin-plated terminals

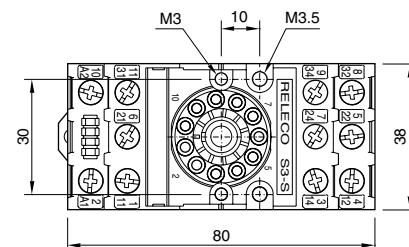
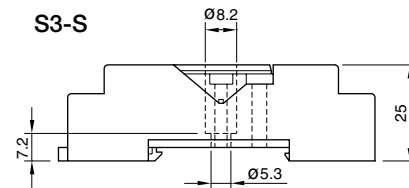
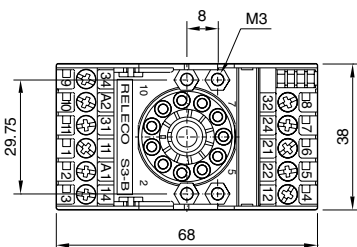
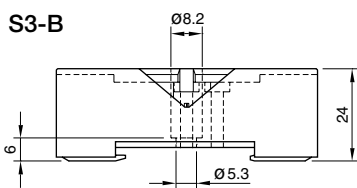
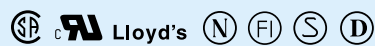

### S3-L S3-PO

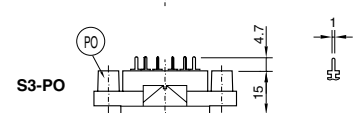
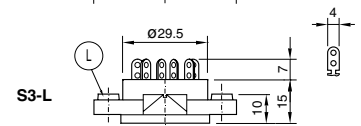
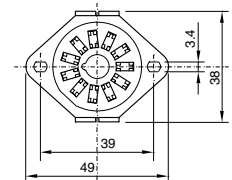

### S3-BC Coding Ring

Can be used to code a specific relay to fit a specific socket up to 11 combinations. Supplied in a pack of 5 pieces.