

**battery type:** Lithium Button Cell  
**battery size:** CR2330  
**chemical system:** Lithium Manganese Dioxide

**nominal voltage:** 3.0 V  
**open circuit voltage:** 3.0...3.4 V (new battery)  
 2.9...3.4 V (after 1 year storage at 20°C)

**Conditions**

all measurements at 22 ± 2°C ambient

**capacity rated:** 250 mAh (continuous discharge at 15kΩ load; 24hours/day End Voltage (EV): 2.0V)

**minimum:** 230 mAh (continuous discharge at 15kΩ load; 24hours/day End Voltage (EV): 2.0V)

**Standard discharge time minimum:** 220 h (at 3kΩ load EV: 2.0V) (for QC measurement)

**Discharge currents standard:** 0.2 mA

**max. recommended current under continuous discharge:** 3 mA

**max. recommended current under pulse discharge:** 20 mA

**Discharge diagrams:**

Discharge Characteristics on Load

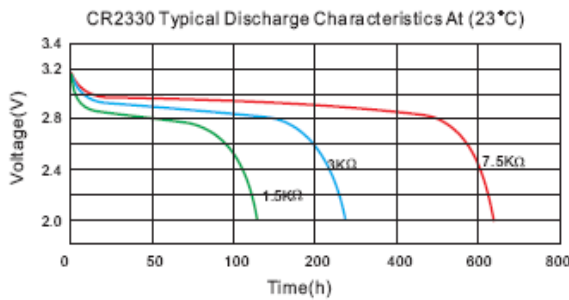

Discharge Characteristics on Temperature

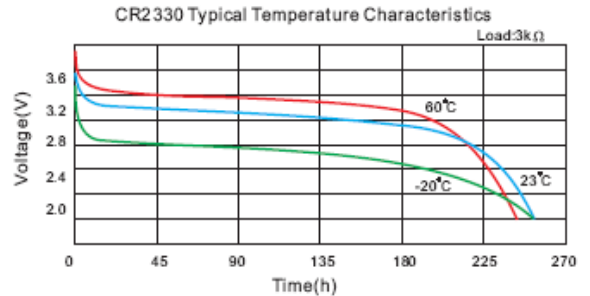

**shelf life:** 10 years under proper storage conditions (ta: ≤ 22°C; RH: 60 ± 15%)

**operating temperature range:** - 20...60 °C

**mechanical specifications:**

dimensions in mm

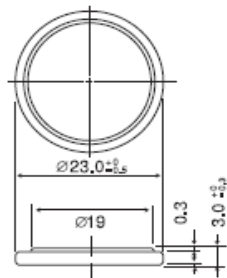

**nominal weight:** 4.0 g



blister card dimensions: 56 x 71.5mm

weight: 5.8g (incl. battery)

	<b>ANSMANN Specifications for model:</b>	<b>CR2330 Lithium Button Cell blister package</b>
	data sheet no. / part no.	1516-0009
	supplier no.	702572
	author / date	TG / 20.03.2013