

# SIEMENS

## Product data sheet

## 3RV1021-0DA10



CIRCUIT-BREAKER,  
0.22...0.32A N-RELEASE 4.2 A, SIZE S0,  
MOTOR PROTECTION, CLASS 10,  
SCREW CONNECTION STANDARD BREAKING  
CAPACITY

### General technical details:

Continuous current / rated value	0.32 A
Adjustable response current	
<ul style="list-style-type: none"> <li>• of the non-delayed short-circuit release           <ul style="list-style-type: none"> <li>• initial value</li> <li>• final value</li> </ul> </li> <li>• of the current-dependent overload release           <ul style="list-style-type: none"> <li>• initial value</li> <li>• final value</li> </ul> </li> </ul>	4.2 A 4.2 A 0.22 A 0.32 A
Switch-off capacity limit short-circuit current / at 400 V / rated value	100 kA
Type of voltage	AC/DC
Service power	
<ul style="list-style-type: none"> <li>• at AC-3 / at 400 V / rated value</li> <li>• for three-phase servomotors / rated value</li> </ul>	0.09 kW 0.09 kW
Number of poles	3
Number of NC contacts / for auxiliary contact	0
Number of NO contacts / for auxiliary contact	0
Number of change-over switches / for auxiliary contact	0

Trip class	CLASS 10
Product function / Overload protection	Yes
<b>Mechanical design:</b>	
Design of the electrical connection / for main current circuit	screw-type terminals
Type of fixing/fixation	screw and snap-on mounting onto 35 mm standard mounting rail according to DIN EN 50022
Product component / auxiliary switch	No
Size of the circuit-breaker	S0
<b>Ambient conditions:</b>	
Protection class IP	IP20

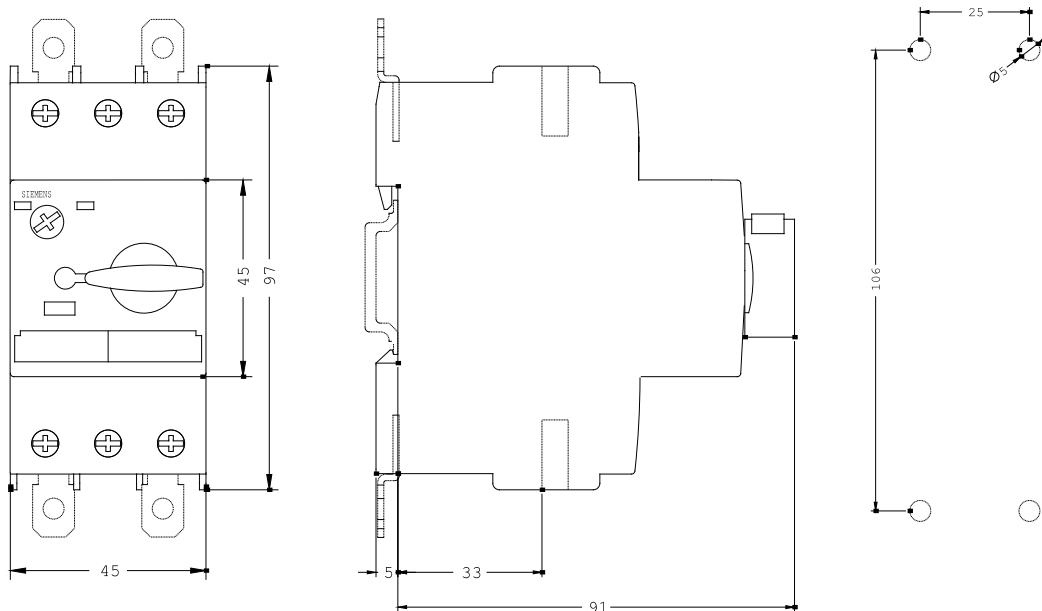

last change:

11/02/2006

<b>Technical Assistance:</b>	Telephone:	+49 (0) 911-895-5900 (8°° - 17°° CET)
	Fax:	+49 (0) 911-895-5907
	E-Mail:	<a href="mailto:technical-assistance@siemens.com">technical-assistance@siemens.com</a>
	Internet:	<a href="http://www.siemens.de/lowvoltage/technical-assistance">www.siemens.de/lowvoltage/technical-assistance</a>