

# Hour meters / timers, electromechanical

## Timers with DIN dimensions

DIN counter for panel mount / DIN rail housing, 48 x 48 mm (AC+DC)

H 57 / AH 57



The hour meters H 57, H 57.55, H 57.72 and AH 57 feature a very high shock resistance. These panel / DIN rail mount counters have a reduced mounting depth. They can be used in many different fields of application. These non-resettable counters are extremely tamper-proof.



### Characteristics

- 7 or 8-digit hour meter
- High shock and impact resistance
- Without reset, small mounting depth
- Magnified large figures
- Protection IP52 (optional IP65), suitable for any mounting position
- UL-approved
- Various front bezel sizes
  - H 57 48 x 48 mm
  - H 57.55 55 x 55 mm
  - H 57.72 72 x 72 mm
  - AH 57 48 x 48 mm for DIN rail

### Benefits

- 5 years guarantee <sup>1)</sup>
- High reliability: for a better sale of your final product
- Data retention in case of power failure
- Long service life

### Applications

General time measurement, maintenance intervals for measuring instruments (respiration units, oxygen, dialysis), small appliances, UV lamps, display panels in vehicles

Hour meters /  
Timers

### Type series

Description	Mounting	Front bezel	Type
Standard DIN timer	clip mounting, on rear	48 x 48 mm [1.89 x 1.89"]	<b>H 57</b>
Standard DIN timer	clip mounting, on rear	55 x 55 mm [1.97 x 1.97"]	<b>H 57.55</b>
Standard DIN timer	clip mounting, on rear	72 x 72 mm [2.83 x 2.83"]	<b>H 57.72</b>
Base mount timer	DIN rail 35 mm [1.38"] acc. to DIN EN 50022		<b>AH 57</b>

Accessories	Dimensions in mm [inch]	Order-No.
<b>Adapter front bezel, 55 x 55 [2.17 x 2.17]</b>	For cut-out 50 x 50 [1.97 x 1.97] or ø 50.5 [2.17] to cut-out 45 x 45 [1.77 x 1.77], with clip mounting for counters 48 x 48 [1.89 x 1.89] black	<b>T008171</b>
<b>Adapter front bezel, 60 x 75 [2.36 x 2.95]</b>	For cut-out 50 x 50 [1.97 x 1.97] to cut-out 45 x 45 [1.77 x 1.77] with screw mounting for counters 48 x 48 [1.89 x 1.89] black	<b>T008860</b>
<b>Adapter front bezel, 72 x 72 [2.83 x 2.83]</b>	For cut-out 68 x 68 [2.68 x 2.68] to cut-out 45 x 45 [1.77 x 1.77] (Mating clip T009420 must be ordered separately) black	<b>T008177</b>
<b>Adapter front bezel, ø 72 [2.83]</b>	For cut-out ø 60 [2.36] to 45 x 45 [1.77 x 1.77], with clip mounting for counters 48 x 48 [1.89 x 1.89] black	<b>N510226</b>
<b>Base-mount socket</b>	For H 57 black	<b>G008040</b>

Suitable gaskets as well as further accessories can be found in the accessories section or in the accessories area of our website at: [www.kuebler.com/accessories](http://www.kuebler.com/accessories).

1) When used as specified in the technical data

## Hour meters / timers, electromechanical

Timers with DIN dimensions	DIN counter for panel mount / DIN rail housing, 48 x 48 mm (AC+DC)	H 57 / AH 57
----------------------------	--	--------------

Technical data		
<b>Electrical connection</b>	screw terminals (tightening torque max. 0.8 Nm) wire entry from behind, for $\varnothing$ 2.5 mm <sup>2</sup> [AWG13]	
<b>Power consumption</b>	10 ... 30 V DC	approx. 500 mW
	100 ... 130 V DC	approx. 750 mW
	20 ... 30 V AC, 50 Hz	approx. 0.3 VA
	42 ... 48 V AC, 50 Hz	approx. 0.25 VA
	100 ... 130 V AC, 50 Hz	approx. 0.6 VA
	187 ... 264 V AC, 50 Hz	approx. 1.2 VA
	360 ... 440 V AC, 50 Hz	approx. 1.65 VA
<b>Rated voltages</b>	AC (50 or 60 Hz)	20 ... 30 V, 42 ... 48 V, 100 ... 130 V, 187 ... 264 V, 360 ... 440 V
	DC	10 ... 30 V, 36 ... 80 V, 100 ... 130 V
<b>On time</b>	100 %	
<b>Number of digits</b>	7 at AC	99999.99 h
	8 at DC	999999.99 h
<b>Count mode</b>	adding	
<b>Height of figures</b>	4 mm [0.16"]	
<b>Colour of figures</b>	white and red on black	
<b>Operating temperature</b>	-15°C ... +50°C [+5°F ... +122°F] (non-condensing)	
<b>Storage temperature</b>	-40°C ... +85°C [-40°F ... +185°F]	
<b>Relative humidity</b>	< 95% (non-condensing)	
<b>Mounting position</b>	any	
<b>Protection</b>	IP52, DIN 40050 (front side)	
<b>Housing</b>	plastic PC (Polycarbonate)	
<b>Accuracy</b>	AC	supply frequency + 30 ms
	DC	< 0.003 % (at 24 h)
<b>Weight</b>	H 57	approx. 48 g [1.69 oz]
	base mount socket no. 48	36 g [1.27 oz]
	slip-on bezel 55	8 g [0.28 oz]
	slip-on bezel 72	13 g [0.46 oz]
<b>Operating indicator of the running time meter</b>	AC	fast rotating wheel with red dashes
	DC	11/100 h display turns continuously by 1 digit in 36 s
<b>Test voltage</b>	2000 V AC, 50 Hz for AC counters	
<b>UL approval</b>	E128604 the version 360 ... 440 V AC is not UL listed	

Options		
<b>Colour of housing</b>	grey	Art.-No. 3.22X.400.XXX
<b>Timer H 57.55 mounted with adapter front bezel 55 x 55 mm [2.17 x 2.17"]</b>	Art.-No. 3.221.XXX.XXX	
<b>Timer H 57.72 montiert mit Adapter-Frontrahmen 72 x 72 mm [2.83 x 2.83"]</b>	Art.-No. 3.222.XXX.XXX	
<b>Electrical connection</b>	flat pin 0.8 x 6.3 mm [0.031 x 0.25"]	Art.-No.: 3.228.401.XXX
<b>IP65 version, welded front cover</b>	H 57	Art.-No. 3.220.XXX.XXX.422
	H 57.55	Art.-No. 3.221.XXX.XXX.423
	H 57.72	Art.-No. 3.222.XXX.XXX.424
<b>Required gaskets</b>	between the counter and the bezel	
	H 57	N511018
<b>Gasket set</b>	H 57.55	N511018 + N511017
	H 57.72	N511018 + N511016
(with the IP65 version, the gasket is included in the delivery)		
Further voltages on request		
Counter with cable inlet from underneath, screw fixing from rear Art.-No. 3.220.401.XXX.044		

# Hour meters / timers, electromechanical

## Timers with DIN dimensions

## DIN counter for panel mount / DIN rail housing, 48 x 48 mm (AC+DC)

## H 57 / AH 57

Standard DIN timer  
clip mounting, on rear

Type H 57

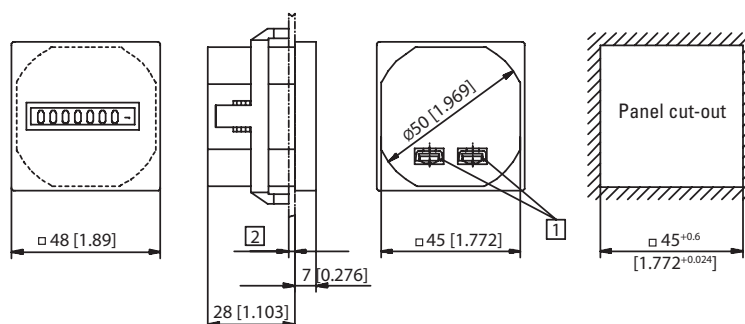

1) Screw terminal with flat pin 0.8 x 6.3 [0.031 x 0.25] 2) max. 9 [0.35]

Type	Display	Voltage	Art.-No. 10 ... 30 V	20 ... 30 V	42 ... 48 V	100 ... 130 V	187 ... 264 V	360 ... 440 V	
H 57	7 digits	AC (50 Hz)		3.220.401.071 <sup>1)</sup>	3.220.401.072	3.220.401.074 <sup>1)</sup>	3.220.401.075 <sup>1)</sup>	3.220.401.079	
		AC (60 Hz)		3.220.401.081 <sup>1)</sup>	3.220.401.082	3.220.401.084 <sup>1)</sup>	3.220.401.085 <sup>1)</sup>	3.220.401.089	
		DC		3.220.401.351 <sup>1)</sup>		3.220.401.381			
Further stock types:			3.220.401.075.422	187... 264 V AC, IP65					
			3.220.401.351.422	10 ... 30 V DC, IP65					

Base mount timer

DIN rail mount 35 [1.38] acc. to DIN EN 50022

Type AH 57

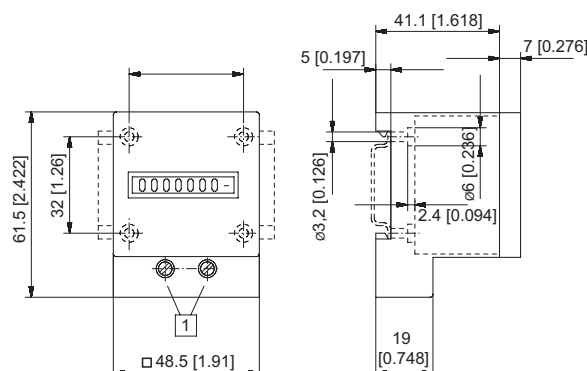

1) Screw terminals

Type	Display	Voltage	Art.-No.	10 ... 30 V	20 ... 30 V	42 ... 48 V	100 ... 130 V	187 ... 264 V	360 ... 440 V
AH 57	7 digits	AC (50 Hz)			3.223.401.071	3.223.401.072	3.223.401.074 <sup>1)</sup>	3.223.401.075 <sup>1)</sup>	3.223.401.079
		AC (60 Hz)			3.223.401.081	3.223.401.082	3.223.401.084 <sup>1)</sup>	3.223.401.085 <sup>1)</sup>	3.223.401.089
		DC			3.223.401.351 <sup>1)</sup>		3.223.401.381		